

Installation Instructions

1801121 2" Receiver Hitch

Applications

2020+ Chevy/GMC 2500/3500 Pickup Truck with Service Body - Excluding Short Bed

Capacity

16,000 lbs. Maximum Gross Trailer Weight (MGTW)
 1,600 lbs. Maximum Vertical Load (MVL)



WARNING

To avoid serious injury or death, check that all hitch fasteners are secure and properly torqued before use.

1. Position the hitch against the frame and align the hitch to the middle hole of the truck rear frame. The other two holes should also line up with the vehicle pre-drilled holes/slots.
2. Clamp the hitch on to the frame temporarily, ensuring that it is centered and flat. Relocate the tire deflector on the frame to fit hitch as needed.
3. Secure the hitch to the frame with six 9/16" bolts (6), two one-holed spacers (4), two two-holed spacers (5), four flat washers (7), six split lock washers (8), and six nuts (9) (See Figure 1).
4. For some model vehicles, if pre-drilled holes are not present, drill as needed.
5. Install service body bumper brackets (NOT INCLUDED) per service body instructions.
6. Using the hitch brackets as a template, drill one 5/8" hole through the bumper brackets on both sides.
7. Attach the bumper brackets to the hitch using two 5/8" bolts (10), four flat washers (11), two split lock washers (12), two nuts (13), and two spacers (14) (See Figure 1). This is required to achieve the rating.
8. Torque all 9/16 fasteners to 110 ft-lb and 5/8" fasteners to 150 ft-lb.

Fig. 1

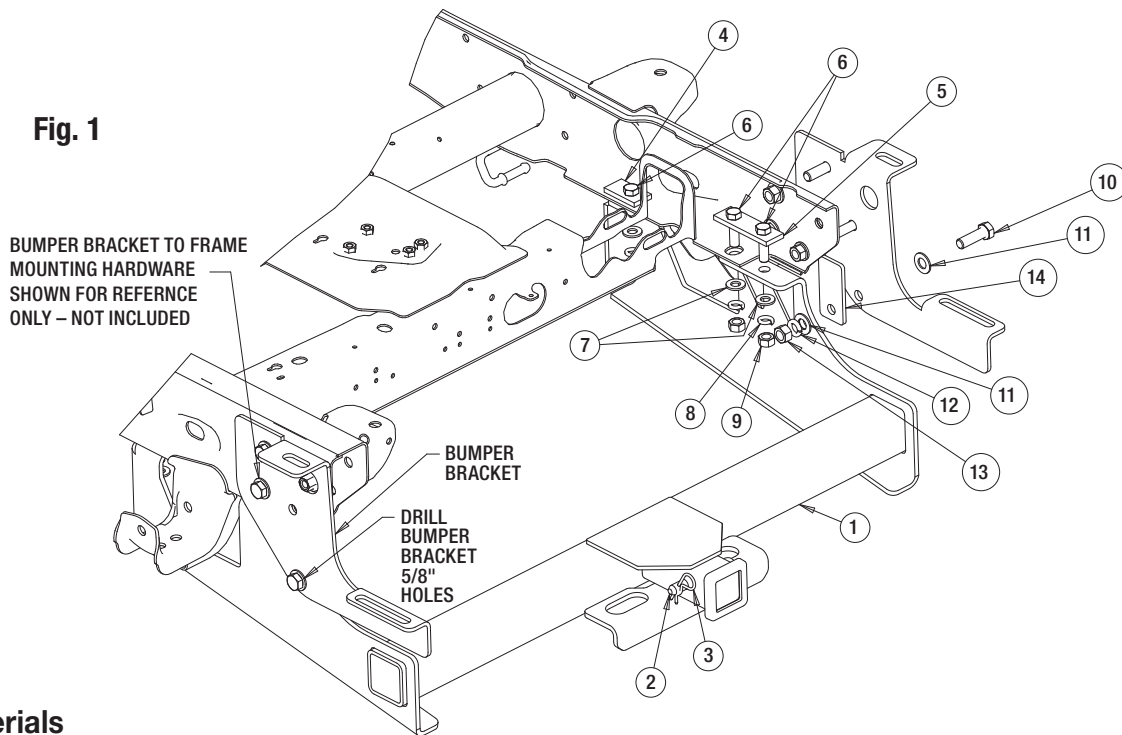

Bill of Materials

ITEM	PART NO.	QTY.	DESCRIPTION
1	3044844	1	HITCH, 2.0 IN RCVR GM, 2500 & 3500
2	HP6256WC1	1	PIN, 5/8 HITCH
3	HP12	1	PIN, HAIR COTTER 5/32" ZN 3.25 OAL
4	3017919	4	SPACER, RECTANGULAR
5	3044847	2	SPACER, RECTANGULAR, HITCH GM 2020+
6	3002476	6	SCREW, HEX HD CAP 9/16-18 X 2 GR8 ZN
7	3034483	6	WASHER, FLAT 9/16 SAE ZN
8	3027910	6	WASHER, SPLIT LOCK 9/16 ZN YEL
9	3018044	6	NUT, HEX 9/16-18 ZN PLATED
10	3023494	2	SCREW, HEX CAP 5/8-11 X 2, GR8 ZY
11	FWF063131095	4	WASHER, 5/8 SAE FLAT ZN
12	3000638	2	WASHER, 5/8" HEAVY DUTY SPLIT LOCK, ZN
13	3017945	2	NUT, HEX, 5/8-11 GRADE 8, ZINC
14	3044851	2	SPACER, VERT. PLATE, HITCH GM 2020+

WARRANTY

Buyers Products Co. warrants all truck/trailer hardware manufactured or distributed by it, to be free from defects in material and workmanship for a period of one year from date of shipment. Parts must be properly installed and used under normal conditions. Any product which has been altered, including modification, misuse, accident or lack of maintenance will not be considered under warranty. Normal wear is excluded. The sole responsibility of Buyers Products Co. under this warranty is limited to repairing or replacing any part or parts which are returned, prepaid, and are found to be defective by Buyers Products Co. Authorization from Buyers Products Co. must be obtained before returning any part. No charges for transportation or labor performed on Buyers' products will be allowed under this warranty.