

Installation Instructions

1801302 2" Receiver Hitch

Applications

2014+ RAM 3500 Bed - Delete

Capacity

17,000 lbs. Maximum Gross Trailer Weight (MGTW)

1,700 lbs. Maximum Vertical Load (MVL)

WARNING

To avoid serious injury or death, check that all hitch fasteners are secure and properly torqued before use.

1. Place the hitch so the end of the hitch is flush to the end of the frame.
2. Clamp the hitch on to the frame temporarily ensuring that it is centered and flat.
3. Align the hole closest to the cab with the hole from the hitch. Secure the hole with a rectangle bolt plate (7) and 1/2" carriage bolt provided. Repeat for both sides of the frame.
4. As shown above, drill 9/16" holes closest to the rear, on both sides.
5. Secure the newly drilled holes with Top Plates (3) and 1/2" carriage bolts.
6. Install the Add On brackets onto the hitch with two carriage bolts on both sides.
7. Install the three 1/2" bolts onto the side of the frame. Secure them with 1/2" fasteners (5, 6 and 8) provided.
8. Torque all 1/2" fasteners with 75 ft-lb.

Fig. 1

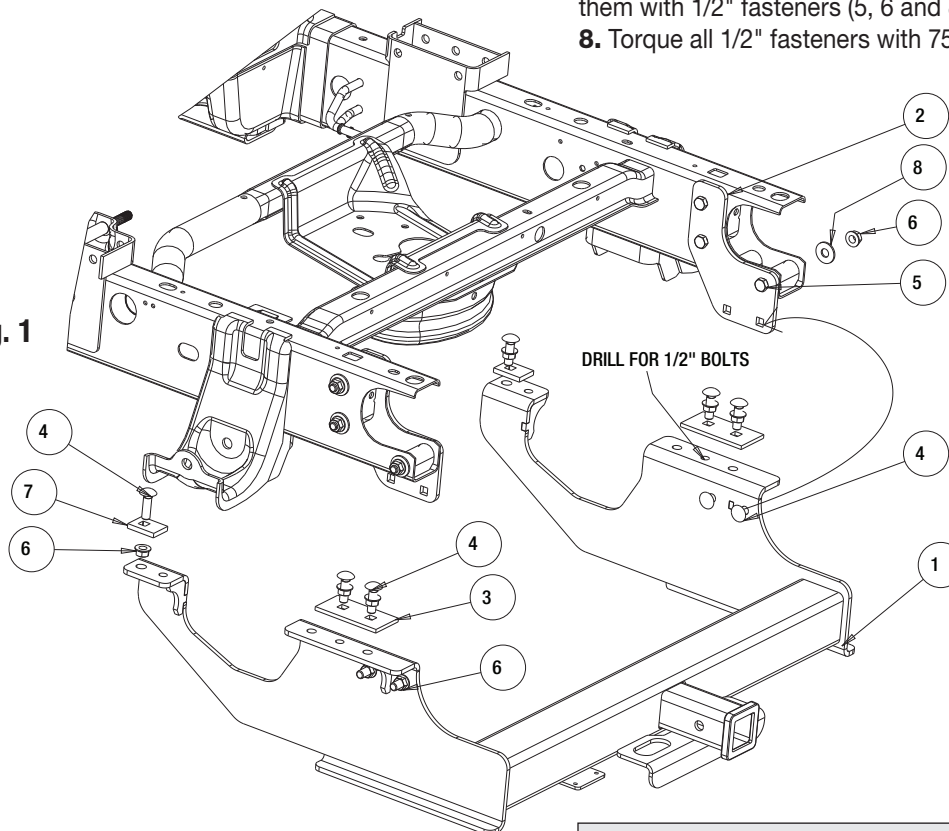

Bill of Materials

ITEM	PART NO.	QTY.	DESCRIPTION
1	3037127	1	HITCH, 2.0" RCVR RAM 3500 BED DEL
2	3035684	2	BRACKET, ADD ON
3	3037410	2	TOP PLATE, DOUBLE SQ. HOLE
4	3029357	10	BOLT, CARRIAGE 1/2-13 X 1.75 GR8 ZN
5	3011717	6	SCREW, HEX HEAD CAP 1/2-13 X 4.00 GR 8 ZN
6	3029359	16	NUT, HX FLNG-1/2-13 ZN G8
7	3014859	2	RECTANGLE, SQUARE HOLE 2IN L
8	FWF050138014	6	WASHER, FLAT, 1/2" USS, ZN

WARRANTY

Buyers Products Co. warrants all truck/trailer hardware manufactured or distributed by it, to be free from defects in material and workmanship for a period of one year from date of shipment. Parts must be properly installed and used under normal conditions. Any product which has been altered, including modification, misuse, accident or lack of maintenance will not be considered under warranty. Normal wear is excluded. The sole responsibility of Buyers Products Co. under this warranty is limited to repairing or replacing any part or parts which are returned, prepaid, and are found to be defective by Buyers Products Co. Authorization from Buyers Products Co. must be obtained before returning any part. No charges for transportation or labor performed on Buyers' products will be allowed under this warranty.