

| REVISION HISTORY |                                |            |
|------------------|--------------------------------|------------|
| REV.             | DESCRIPTION                    | DATE       |
| 01               | PRELIMINARY RELEASE PER EL0056 | 2016-10-28 |
| 02               | REVISED PER EL0056             | 2016-11-01 |
| A                | INITIAL RELEASE PER EL0056     | 2016-11-28 |

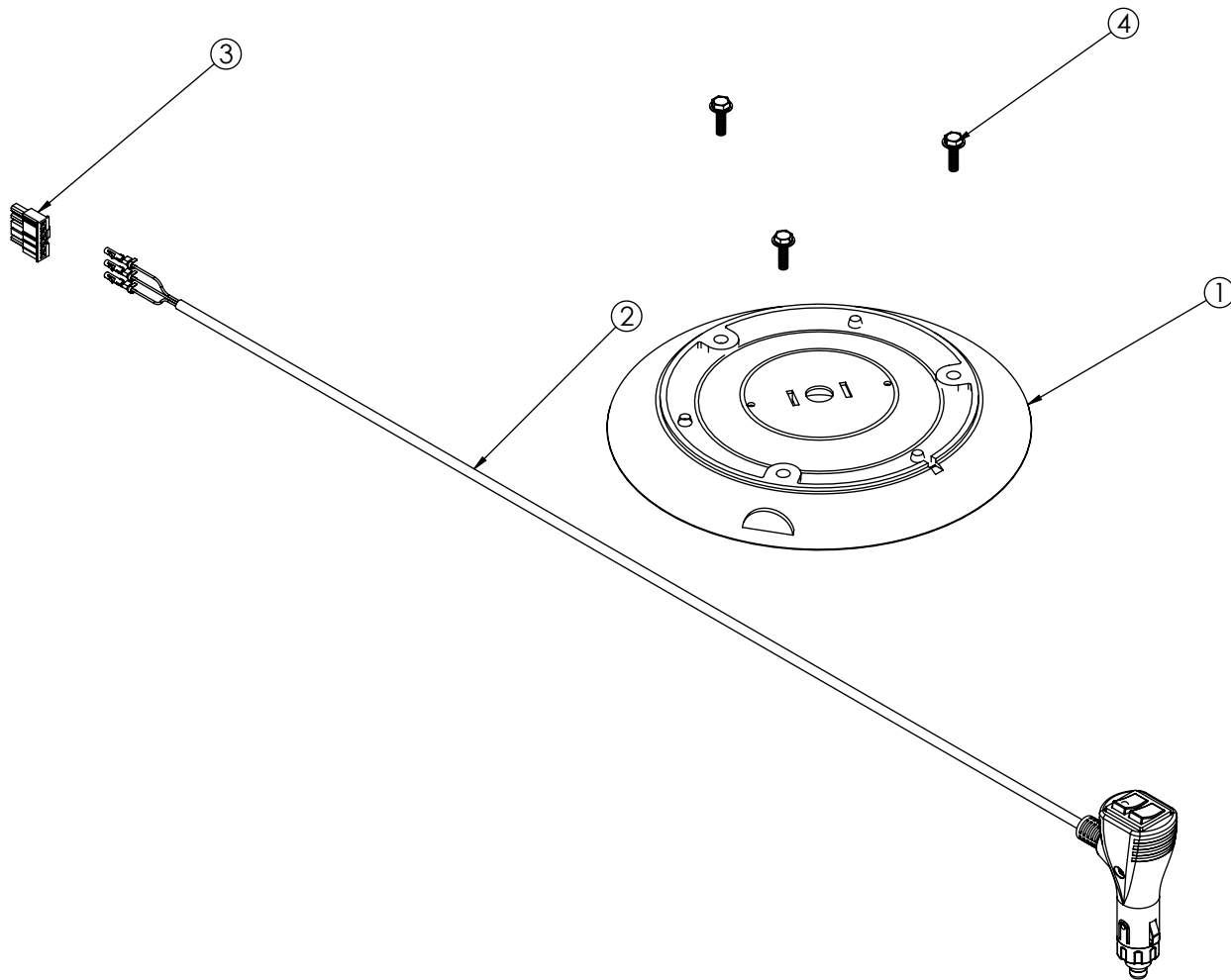

| ITEM NO. | QTY. | DESCRIPTION                                  | COMMENTS  |
|----------|------|----------------------------------------------|-----------|
| 1        | 1    | ASSY, MAGNET PLATE & COVER, RUBBER           |           |
| 2        | 1    | ASSY, SUB, 2 SWITCH CABLE, 5585XX-VM         |           |
| 3        | 1    | CON, HO, MOLEX, 39-01-4051, 5P               |           |
| 4        | 3    | SCREW, TAPTITE II, HEX/WASHER, 8-32 X 1/2    |           |
| 5        | 1    | SHEET, INSTRUCTION, 5545/550 SERIES, TRILNGL | NOT SHOWN |
| 6        | 1    | BOX, CORRUGATED, PLAIN, 5700, 360*           | NOT SHOWN |
| 7        | 1    | BAG, RECLOSABLE 3 X 5 X 2 MIL                | NOT SHOWN |
| 8        | 1    | TIE STRAP, 7" T&B TY25MX                     | NOT SHOWN |

| SCALE 1:3.5                                                                                                                                                                                                                                                      | APPROVALS                                | DATE                              |        |                             |                                          |                                   |               |            |
|------------------------------------------------------------------------------------------------------------------------------------------------------------------------------------------------------------------------------------------------------------------|------------------------------------------|-----------------------------------|--------|-----------------------------|------------------------------------------|-----------------------------------|---------------|------------|
| CAD GENERATED DRAWING<br>DO NOT MANUALLY UPDATE.<br>MODEL REFERENCED: A                                                                                                                                                                                          | DRAWN BY ABB                             | 2016-11-01                        |        |                             |                                          |                                   |               |            |
|                                                                                                                                                                                                                                                                  | CHECKED ABB                              | 2016-11-10                        |        |                             |                                          |                                   |               |            |
| TOLERANCES ARE IN INCHES, AND MILLIMETERS<br>TOLERANCES UNLESS OTHERWISE STATED ARE:                                                                                                                                                                             | MECH. ENG. KLR                           | 2016-11-02                        |        |                             |                                          |                                   |               |            |
|                                                                                                                                                                                                                                                                  | ELEC. ENG.                               |                                   |        |                             |                                          |                                   |               |            |
| <table border="1"> <tr> <th>MILLIMETERS DECIMALS</th> <th>INCHES DECIMALS</th> <th>ANGLES</th> </tr> <tr> <td>XX. ± 1.0mm<br/>XX.X ± 0.5mm</td> <td>X.X ± 0.1<br/>X.XX ± 0.04<br/>X.XXX ± 0.02</td> <td>± 0.5°<br/><br/>FRACTIONS<br/>± 1/64</td> </tr> </table> | MILLIMETERS DECIMALS                     | INCHES DECIMALS                   | ANGLES | XX. ± 1.0mm<br>XX.X ± 0.5mm | X.X ± 0.1<br>X.XX ± 0.04<br>X.XXX ± 0.02 | ± 0.5°<br><br>FRACTIONS<br>± 1/64 | TEST ENG. JRT | 2016-11-07 |
|                                                                                                                                                                                                                                                                  | MILLIMETERS DECIMALS                     | INCHES DECIMALS                   | ANGLES |                             |                                          |                                   |               |            |
| XX. ± 1.0mm<br>XX.X ± 0.5mm                                                                                                                                                                                                                                      | X.X ± 0.1<br>X.XX ± 0.04<br>X.XXX ± 0.02 | ± 0.5°<br><br>FRACTIONS<br>± 1/64 |        |                             |                                          |                                   |               |            |
|                                                                                                                                                                                                                                                                  | SALES. JPT                               | 2016-11-18                        |        |                             |                                          |                                   |               |            |

www.eccolink.com

Americas (800) 635-5900 | Europe +44 (0)113 237 5340 | Asia Pacific +61 (0)3 63322444

**ACCESSORY KIT, VACUUM MOUNT, 5545 SERIES**

CUSTOMER PART NO. **A5545VMK**      PRODUCT SERIES: **ACCESSORY**

**NON DISCLOSURE AGREEMENT**  
 THIS DRAWING AND THE DESIGN IT DISCLOSES ARE THE PRIVATE PROPERTY OF ESG AND IS ISSUED IN CONFIDENCE FOR ENGINEERING INFORMATION ONLY. THE DRAWING AND / OR DESIGN MAY NOT BE USED, COPIED, REPRODUCED, OR OTHERWISE DISCLOSED IN PART OR AS A WHOLE TO OUTSIDERS OR USED FOR ANY OTHER PURPOSE WITHOUT THE PRIOR WRITTEN CONSENT OF ESG. THE DRAWING IS SUBJECT TO RECALL AT ANY TIME. YOUR POSSESSION OF THIS DOCUMENT CONSTITUTES ACCEPTANCE OF THESE TERMS. © 2016 ECCO

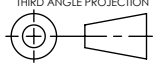

|                                           |                          |                          |
|-------------------------------------------|--------------------------|--------------------------|
| SIZE: A                                   | DWG. NO. <b>A5545VMK</b> | REV. <b>A</b>            |
| Electronically Controlled Use Latest Copy |                          |                          |
| SHEET 1 OF 1                              | Project: EL0056          | Date Created: 2016-10-28 |