

INSTALLATION AND CONFIGURATION MANUAL ABRAMS STAREYE SERIES LED BEACON

MODEL# SB-400 / SB-700

WARNING:

FAILURE TO INSTALL OR USE THIS PRODUCT ACCORDING TO MANUFACTURER'S RECOMMENDATIONS MAY RESULT IN PROPERTY DAMAGE, SERIOUS INJURY, AND/OR DEATH.

IMPORTANT:

PLEASE READ ALL OF THE FOLLOWING INSTRUCTIONS BEFORE INSTALLING YOUR NEW ABRAMS STAREYE SERIES BEACON.

- PROPER INSTALLATION OF THIS PRODUCT REQUIRES THE INSTALLER TO HAVE A GOOD UNDERSTANDING OF AUTOMOTIVE ELECTRONICS, SYSTEMS AND PROCEDURES.
- THIS PRODUCT CONTAINS HIGH-INTENSITY LEDS. DO NOT STARE DIRECTLY INTO THESE LIGHTS. MOMENTARY BLINDNESS AND/OR EYE DAMAGE COULD RESULT.
- DO NOT INSTALL THIS PRODUCT OR ROUTE ANY WIRES IN THE DEPLOYMENT AREA OF YOUR AIR BAG. EQUIPMENT MOUNTED OR LOCATED IN THE AIR BAG DEPLOYMENT AREA WILL DAMAGE OR REDUCE THE EFFECTIVENESS OF THE AIR BAG, OR BECOME A PROJECTILE THAT COULD CAUSE SERIOUS PERSONAL INJURY OR DEATH. REFER TO YOUR VEHICLE OWNER MANUAL FOR THE AIR BAG DEPLOYMENT AREA. THE USER/INSTALLER ASSUMES FULL RESPONSIBILITY TO DETERMINE PROPER MOUNTING LOCATION, BASED ON PROVIDING ULTIMATE SAFETY TO ALL PASSENGERS INSIDE THE VEHICLE.
- IF MOUNTING THIS PRODUCT REQUIRES DRILLING HOLES, THE INSTALLER MUST BE SURE THAT NO VEHICLE COMPONENTS OR OTHER VITAL PARTS COULD BE DAMAGED BY THE DRILLING PROCESS. CHECK BOTH SIDES OF THE MOUNTING SURFACE BEFORE DRILLING BEGINS. ALSO DE-BURR ANY HOLES AND REMOVE ANY METAL SHARDS OR REMNANTS. INSTALL GROMMETS INTO ALL WIRE PASSAGE HOLES.

- INSPECT AND OPERATE THIS PRODUCT REGULARLY TO CONFIRM ITS PROPER OPERATION AND MOUNTING CONDITION. DO NOT USE A PRESSURE WASHER TO CLEAN THIS PRODUCT.
- FOR THIS PRODUCT TO OPERATE AT OPTIMUM EFFICIENCY, A GOOD ELECTRICAL CONNECTION TO CHASSIS GROUND MUST BE MADE. THE RECOMMENDED PROCEDURE REQUIRES THE PRODUCT GROUND WIRE TO BE CONNECTED DIRECTLY TO THE NEGATIVE (-) BATTERY POST.
- IT IS RECOMMENDED THAT THESE INSTRUCTIONS BE STORED IN A SAFE PLACE AND REFERRED TO WHEN PERFORMING MAINTENANCE AND/OR REINSTALLATION OF THIS PRODUCT.
- FAILURE TO FOLLOW THESE SAFETY PRECAUTIONS AND INSTRUCTIONS COULD RESULT IN DAMAGE TO THE PRODUCT OR VEHICLE AND/OR SERIOUS INJURY TO YOU AND YOUR PASSENGERS!
- IF THIS PRODUCT USES A REMOTE DEVICE TO ACTIVATE OR CONTROL THIS PRODUCT, MAKE SURE THAT THIS CONTROL IS LOCATED IN AN AREA THAT ALLOWS BOTH THE VEHICLE AND THE CONTROL TO BE OPERATED SAFELY IN ANY DRIVING CONDITION.
- DO NOT ATTEMPT TO ACTIVATE OR CONTROL THIS DEVICE IN A HAZARDOUS DRIVING SITUATION

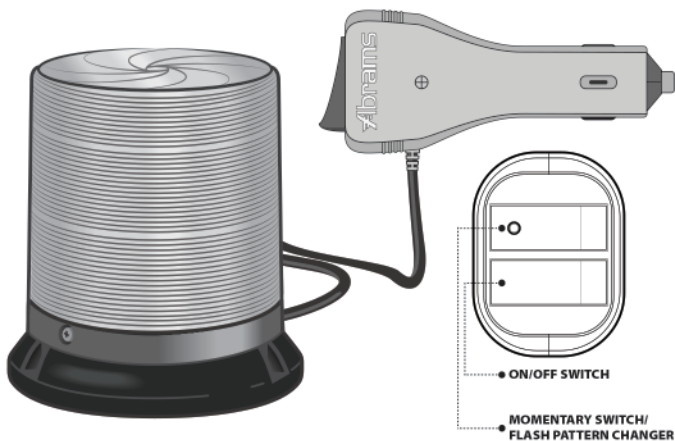

1. Changing Patterns: Patterns can be changed by momentarily connecting the blue wire to the ground of your vehicle's battery.

Less than 1 Second	Next Pattern
1-3 Seconds	Previous Pattern
3-5 Seconds	Factory Default
5+ Seconds	Turn off and Reset

2. Syncing Instructions: Configure both intensity light heads to the same pattern in Phase 1 and connect the yellow wires from each light head together.

3. Alternating Light Heads: Set every other light to the same pattern in Phase 2 and connect the blue wires. To better understand how this feature works, each lighthouse coming from the factory will display Phase 1. In order to have one Intensity light head alternate with another, every other light needs to be advanced to the current pattern's Phase 2.

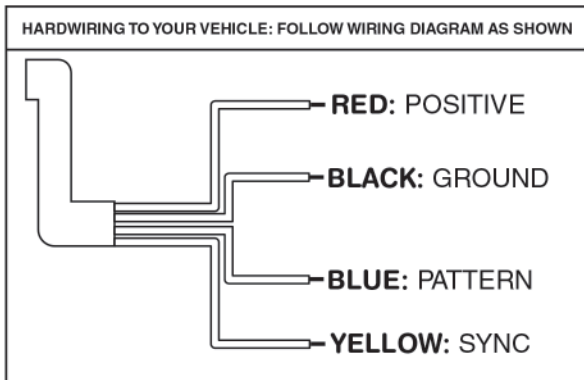

OPERATION FOR HARDWIRING TO YOUR VEHICLE

BLACK	NEGATIVE/GROUND
BLUE	PATTERN SWITCH
YELLOW	SYNCHRONIZED FUNCTION
RED	POSITIVE (NEED TO ADD 2A FUSE)

PACKAGE CONTENTS:

- STAREYE BEACON
- COLORED LENS
- CIGARETTE LIGHTER ADAPTER
- 17lb MAGENT
- PRODUCT MANUAL

ABRAMS STAREYE LED BEACON SPECIFICATIONS

INPUT VOLTAGE	10-30VDC
WORK CURRENT	12V - 1.8A (MAX) 24V - 1.0A (MAX)
WATERPROOF	IP67

Recommend Operation Environment

Ambient Temperature: -30 to 50

Relative Humidity: 10 to 85% , non-condensing

INSTALLATION AND CONFIGURATION MANUAL ABRAMS STAREYE SERIES LED BEACON

MOUNTING

Surface Mounting (See Figure 1.)

Magnetic/Suction Cup Mounting

1. Clean the surface thoroughly before mounting.
2. For suction cup mounting, clean the suction cups before applying to the surface.
3. Place the beacon on its proposed mounting location and apply pressure for a good seal.

Permanent Mounting, (See Figure 2.)

1. Select the mounting location for your Stareye Beacon and mark the three mounting holes.
2. Using a drill, make three holes and a central wire passage hole.
3. Secure the beacon with three screws (customer supplied) Choose the right screws depending on your mounting location.

Pipe Mounting (See Figure 3.)

Please note: pipe mount is designed for 1" pipes,

1. Route cable through the pipe.
2. Screw the beacon on to the pipe. Be careful not to damage the wires during the process.

STAREYE LED BEACON FLASH PATTERNS

1. SINGLE FLASH 75 FPM PHASE 1 (SIM) - SYNC	16. DOUBLE FLASH ROTATOR 130 FPM
2. SINGLE FLASH 75 FPM PHASE 2 (SIM) - SYNC	17. TRIPLE FLASH 130 FPM PHASE 1 (SIM) - SYNC
3. SINGLE FLASH ROTATOR 75 FPM	18. TRIPLE FLASH 130 FPM PHASE 2 (SIM) - SYNC
4. SINGLE FLASH ROTATOR 100 FPM	19. QUAD FLASH 75 FPM PHASE 1 (SIM) - SYNC
5. SINGLE FLASH 120 FPM PHASE 1 (SIM) - SYNC	20. QUAD FLASH 75 FPM PHASE 2 (SIM) - SYNC
6. SINGLE FLASH 120 FPM PHASE 2 (SIM) - SYNC	21. QUAD FLASH ROTATOR 75 FPM
7. SINGLE FLASH ROTATOR 120 FPM	22. ECE R65 ROTATOR FLASH 120
8. SINGLE FLASH ROTATOR 150 FPM	23. ECE R65 ROTATOR FLASH 60
9. SINGLE FLASH 375 FPM PHASE 1 (SIM) - SYNC	24. CA T13 SINGLE FLASH 75FPM (SIM)
10. SINGLE FLASH 375 FPM PHASE 2 (SIM) - SYNC	25. CA T13 DOUBLE FLASH 75FPM (SIM)
11. SINGLE FLASH ROTATOR 375 FPM	26. NFPA-QUAD FLASH 75FPM (SIM)
12. DOUBLE FLASH 75 FPM PHASE 1 (SIM) - SYNC	27. MODUFLASH (SIM)
13. DOUBLE FLASH 75 FPM PHASE 2 (SIM) - SYNC	28. AUTORUN (RANDOM)
14. DOUBLE FLASH 130 FPM PHASE 1 (SIM) - SYNC	29. STEADY BURN
15. DOUBLE FLASH 130 FPM PHASE 2 (SIM) - SYNC	30. OFF

MAGNET MOUNT

FIGURE 1.

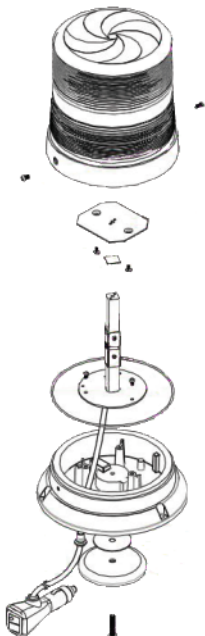

PERMANENT MOUNT

FIGURE 2.

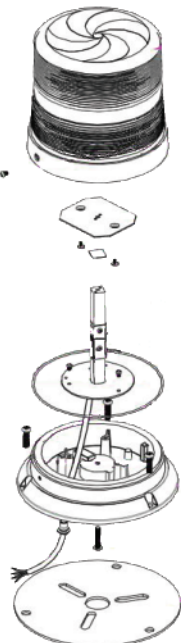

POLE MOUNT

FIGURE 3.

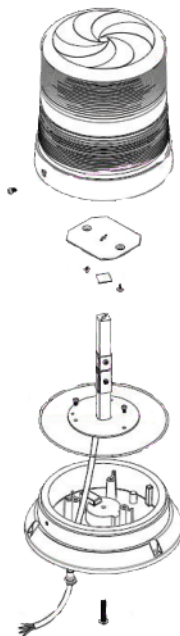

TROUBLESHOOTING:

THE STAREYE BEACON SERIES HAS BEEN FACTORY TESTED AND APPROVED. IF THE FUNCTIONS OF THE DEVICE FAIL, PLEASE CHECK THE FOLLOWING:

1. AFTER CONNECTING THE POWER SUPPLY, BE SURE THAT THE POWER SOURCE END IS JOINED IN THE CORRECT WAY AND THEN, ENSURE THAT THERE IS NO SHORT CIRCUIT POWER OCCURRING.
2. ENSURE POWER SWITCH IS TURNED TO "ON" POSITION.
3. PRESS THE PATTERN SWITCH TO BE SURE THE "OFF" PATTERN IS NOT SELECTED. IF THE BLUE WIRE TOUCHES BLACK WIRE OVER 5 SECONDS, IT WOULD SWITCH TO OFF PATTERN. IT WOULD LIGHT UP AGAIN WHEN THE BLUE WIRE TOUCHES THE BLACK WIRE FOR LESS THAN 1 SECOND.

MODEL#	WITHOUT BASE	WITH BASE
SB-004	4.1" D 4" H	5.1" D 4" H
SB-007	5.125" D 7" H	6.5" D 7" H

**IF YOU REQUIRE ADDITIONAL INFORMATION AND/OR VIDEO AND USER GUIDES, PLEASE VISIT WWW.ABRAMSMFG.COM/SUPPORT OR CALL ABRAMS CUSTOMER SUPPORT 844.9.ABRAMS

WARRANTY (5 YEAR WARRANTY)

THIS PRODUCT WAS TESTED AND FOUND TO BE OPERATIONAL AT THE TIME OF MANUFACTURE. PROVIDED THIS PRODUCT IS INSTALLED AND OPERATED IN ACCORDANCE WITH THE MANUFACTURER'S RECOMMENDATIONS, ABRAMS GUARANTEES THIS PRODUCT FOR A PERIOD OF 5 YEARS FROM THE DAY OF PURCHASE OR DELIVERY, WHICH EVER IS LATER. UNITS DEMONSTRATED TO BE DEFECTIVE WITHIN THE WARRANTY PERIOD WILL BE REPLACED. IMPROPER INSTALLATION OR USE OF INAPPROPRIATE OR INADEQUATE WIRING OR CIRCUIT PROTECTION CAUSES THE WARRANTY TO BE VOID. FAILURE OR DESTRUCTION OF THE PRODUCT RESULTING FROM ABUSE OR UNUSUAL USE AND/OR ACCIDENTS IS NOT COVERED BY THIS WARRANTY. ABRAMS SHALL IN NO WAY BE LIABLE FOR OTHER DAMAGES INCLUDING CONSEQUENTIAL, INDIRECT OR SPECIAL DAMAGES WHETHER LOSS IS DUE TO NEGLIGENCE OR BREACH OF WARRANTY. ABRAMS MAKES NO OTHER EXPRESS OR IMPLIED WARRANTY INCLUDING, WITHOUT LIMITATION, WARRANTIES OF FITNESS OR MERCHANTABILITY, WITH RESPECT THIS PRODUCT.

