

# WHELEN<sup>®</sup>

## ENGINEERING COMPANY INC.

51 Winthrop Road  
Chester, Connecticut 06412-0684  
Phone: (860) 526-9504  
Internet: [www.whelen.com](http://www.whelen.com)  
Sales e-mail: [autosale@whelen.com](mailto:autosale@whelen.com)  
Customer Service e-mail: [custserv@whelen.com](mailto:custserv@whelen.com)

**Installation Guide:  
4500-series Lightbars**

### Warnings to Installers

Whelen's emergency vehicle warning devices must be properly mounted and wired in order to be effective and safe. Read and follow all of Whelen's written instructions when installing or using this device. Emergency vehicles are often operated under high speed stressful conditions which must be accounted for when installing all emergency warning devices. Controls should be placed within convenient reach of the operator so that they can operate the system without taking their eyes off the roadway. Emergency warning devices can require high electrical voltages and/or currents. Properly protect and use caution around live electrical connections. Grounding or shorting of electrical connections can cause high current arcing, which can cause personal injury and/or vehicle damage, including fire. Many electronic devices used in emergency vehicles can create or be affected by electromagnetic interference. Therefore, after installation of any electronic device it is necessary to test all electronic equipment simultaneously to insure that they operate free of interference from other components within the vehicle. Never power emergency warning equipment from the same circuit or share the same grounding circuit with radio communication equipment. All devices should be mounted in accordance with the manufacturer's instructions and securely fastened to vehicle elements of sufficient strength to withstand the forces applied to the device. Driver and/or passenger air bags (SRS) will affect the way equipment should be mounted. This device should be mounted by permanent installation and within the zones specified by the vehicle manufacturer, if any. Any device mounted in the deployment area of an air bag will damage or reduce the effectiveness of the air bag and may damage or dislodge the device. Installer must be sure that this device, its mounting hardware and electrical supply wiring does not interfere with the air bag or the SRS wiring or sensors. Mounting the unit inside the vehicle by a method other than permanent installation is not recommended as unit may become dislodged during swerving; sudden braking or collision. Failure to follow instructions can result in personal injury. Whelen assumes no liability for any loss resulting from the use of this warning device. **PROPER INSTALLATION COMBINED WITH OPERATOR TRAINING IN THE PROPER USE OF EMERGENCY WARNING DEVICES IS ESSENTIAL TO INSURE THE SAFETY OF EMERGENCY PERSONNEL AND THE PUBLIC.**

### Warnings to Users

Whelen's emergency vehicle warning devices are intended to alert other operators and pedestrians to the presence and operation of emergency vehicles and personnel. However, the use of this or any other Whelen emergency warning device does not guarantee that you will have the right-of-way or that other drivers and pedestrians will properly heed an emergency warning signal. Never assume you have the right-of-way. It is your responsibility to proceed safely before entering an intersection, driving against traffic, responding at a high rate of speed, or walking on or around traffic lanes. Emergency vehicle warning devices should be tested on a daily basis to ensure that they operate properly. When in actual use, the operator must ensure that both visual and audible warnings are not blocked by vehicle components (i.e.: open trunks or compartment doors), people, vehicles, or other obstructions. It is the user's responsibility to understand and obey all laws regarding emergency warning devices. The user should be familiar with all applicable laws and regulations prior to the use of any emergency vehicle warning device. Whelen's audible warning devices are designed to project sound in a forward direction away from the vehicle occupants. However, because sustained periodic exposure to loud sounds can cause hearing loss, all audible warning devices should be installed and operated in accordance with the standards established by the National Fire Protection Association.

### Safety First

This document provides all the necessary information to allow your Whelen product to be properly and safely installed. Before beginning the installation and/or operation of your new product, the installation technician and operator must read this manual completely. Important information is contained herein that could prevent serious injury or damage.

**⚠ WARNING:** This product can expose you to chemicals including Methylene Chloride which is known to the State of California to cause cancer, and Bisphenol A, which is known to the State of California to cause birth defects or other reproductive harm. For more information go to [www.P65Warnings.ca.gov](http://www.P65Warnings.ca.gov).

- **Proper installation of this product requires the installer to have a good understanding of automotive electronics, systems and procedures.**
- **Whelen Engineering requires the use of waterproof butt splices and/or connectors if that connector could be exposed to moisture.**
- **Any holes, either created or utilized by this product, should be made both air- and watertight using a sealant recommended by your vehicle manufacturer.**
- **Failure to use specified installation parts and/or hardware will void the product warranty.**
- **If mounting this product requires drilling holes, the installer MUST be sure that no vehicle components or other vital parts could be damaged by the drilling process. Check both sides of the mounting surface before drilling begins. Also de-burr the holes and remove any metal shards or remnants. Install grommets into all wire passage holes.**
- **If this manual states that this product may be mounted with suction cups, magnets, tape or Velcro®, clean the mounting surface with a 50/50 mix of isopropyl alcohol and water and dry thoroughly.**
- **Do not install this product or route any wires in the deployment area of your air bag. Equipment mounted or located in the air bag deployment area will damage or reduce the effectiveness of the air bag, or become a projectile that could cause serious personal injury or death. Refer to your vehicle owner's manual for the air bag deployment area. The User/Installer assumes full responsibility to determine proper mounting location, based on providing ultimate safety to all passengers inside the vehicle.**
- **For this product to operate at optimum efficiency, a good electrical connection to chassis ground must be made. The recommended procedure requires the product ground wire to be connected directly to the NEGATIVE (-) battery post (this does not include products that use cigar power cords).**
- **If this product uses a remote device for activation or control, make sure that this device is located in an area that allows both the vehicle and the device to be operated safely in any driving condition.**
- **Do not attempt to activate or control this device in a hazardous driving situation.**
- **This product contains either strobe light(s), halogen light(s), high-intensity LEDs or a combination of these lights. Do not stare directly into these lights. Momentary blindness and/or eye damage could result.**
- **Use only soap and water to clean the outer lens. Use of other chemicals could result in premature lens cracking (crazing) and discoloration. Lenses in this condition have significantly reduced effectiveness and should be replaced immediately. Inspect and operate this product regularly to confirm its proper operation and mounting condition. Do not use a pressure washer to clean this product.**
- **It is recommended that these instructions be stored in a safe place and referred to when performing maintenance and/or reinstallation of this product.**
- **FAILURE TO FOLLOW THESE SAFETY PRECAUTIONS AND INSTRUCTIONS COULD RESULT IN DAMAGE TO THE PRODUCT OR VEHICLE AND/OR SERIOUS INJURY TO YOU AND YOUR PASSENGERS!**

**IMPORTANT! The lightbar should be located a minimum of 16" from any radio antennas!**

**Installation:**

**Note:** When routing wires, it is important to choose a path that will keep them away from excessive heat or any vehicle equipment that could compromise the wires integrity.

1. This lightbar mounts with 1-1/4" bolts extending from the rear of the housing. Position the unit in its exact mounting location and use an awl or other suitable tool to scribe the areas to be drilled (Fig. 1).
2. Remove the lightbar. Using a drill bit sized for a 3/8" step bolt, drill a hole in each of the areas scribed in step 1. Return the lightbar to its mounting location and secure it to the vehicle with supplied hardware.

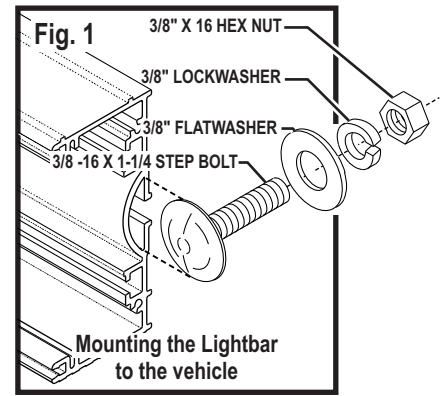

**Wiring:**

**WARNING:** All Customer supplied wires that connect to the positive terminal of the battery must be sized to supply at least 125% of the maximum operating current and FUSED at the battery to carry that load. **DO NOT USE CIRCUIT BREAKERS WITH THIS PRODUCT!**

**IMPORTANT!** All Positive input wires must be individually fused. Due to the large number of possible configurations, each with their own fusing requirements, it is the installation technician's responsibility to determine the maximum current draw for each input wire and fuse that wire at 125% of that value.

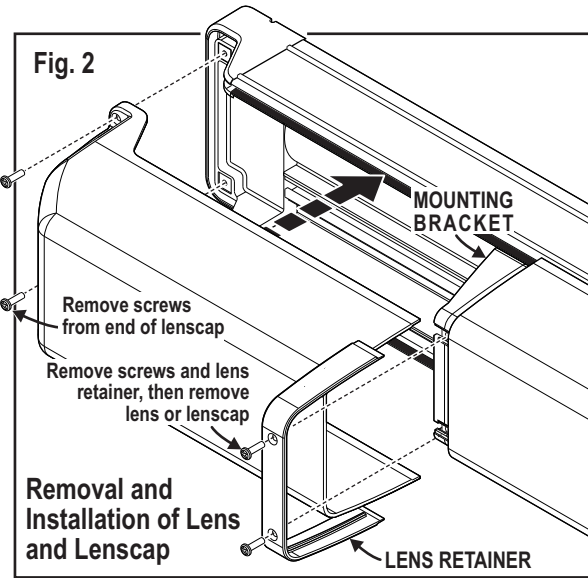

**Servicing your lightbar:**

**NOTE:** Before opening your lightbar for service or repair always be sure to Disconnect the lightbar from it's power source. (See strobe light warning below.)

**Lens or Lenscap: Removal or Installation**

1. To remove a lenscap, remove the 2 screws from the end of the lenscap, and the 2 screws from the opposite side that thread through the lens retainer into the lighthouse mounting bracket. Pull the lenscap off (Fig. 2).
2. To remove a lens, remove the 4 phillips head screws that thread through the lens retainer into the lighthouse mounting bracket and then pull the lens off.

**Removing an Existing Rotator:**

1. Disconnect the lightbar from power. **WARNING:** For lightbars with strobe lights, wait a minimum of 10 minutes before proceeding.
2. Remove the lens or lenscap in front of the rotator you wish to replace.
3. Disconnect the rotator from the

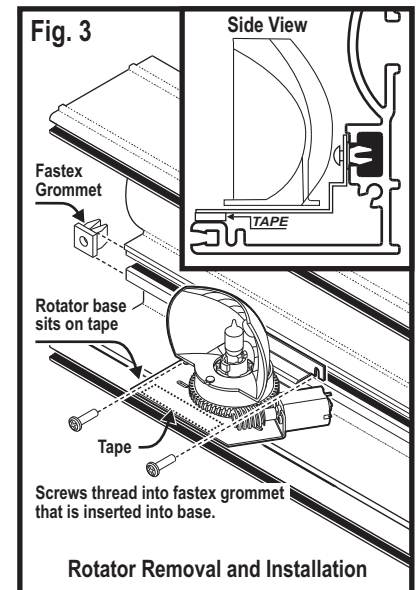

4. Loosen the two screws that secure the rotator base to the extrusion (2 or 3 turns) and lift the rear of the rotator base then remove the rotator from the extrusion.

**Installation of a New Rotator:**

1. Remove any adhesive tape on the lightbar base left from the old rotator.
2. Remove the backing from the piece of 2-sided tape and apply it to the lightbar base in the same location as the previous tape (Fig. 3).
3. Plug the new rotator into the old rotator's harness plug.
4. Place the new rotator inside the extrusion in the same area the old rotator was removed from but don't tighten the screws yet.
5. Remove the backing from the tape and press the rotator base down onto the lightbar base firmly, being careful not pinch any wires between the base and extrusion, then tighten the mounting screws.
6. Reconnect lightbar to power and test for proper operation then return any lenscaps or lenses you had to remove.

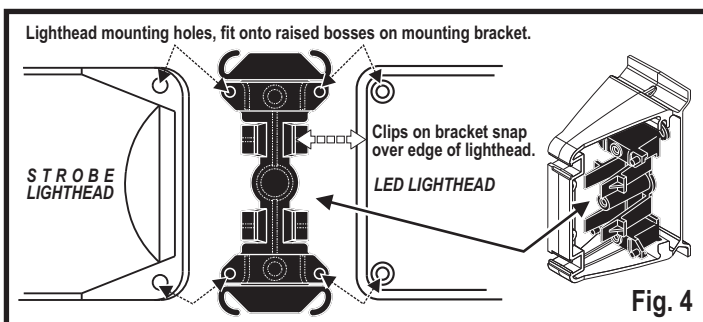

**Servicing Lighthouses: Strobe, Halogen or LED**

**WARNING:** The strobe light power supply is a high voltage device. Do not touch or remove the strobe tube assembly while in operation. Wait 10 minutes after disconnecting the unit from its power source before starting any work or trouble shooting.

**Removal and Installation**

1. Disconnect the lightbar from it's power source.
2. To remove the lighthouse, first remove the lens or lenscap necessary to access the lighthouse you wish to service or replace.

- Now pull the clips back on the mounting bracket that secure the lighthead as you lift the lighthead off of the raised bosses on the bracket (Fig. 4).
- Being careful not to pull out any wires, lift the lighthead out of the lightbar base, disconnect its connector from the lightbar wiring harness, then lift the lighthead out of the lightbar.
- To reinstall the lighthead, plug the lighthead's connector into the lightbar, snap it back into the brackets and replace any lenses or lenscaps you removed.

**Corner Strobe / Removal:**

- Disconnect the lightbar from its power source and remove the endcap in front of the lighthead you wish to replace or service (**See strobe warning**).
- Spread the ends of the corner strobe support bracket (A) apart to disengage it from the tab on the lighthead, and lift this end of the lighthead out (Fig. 5).
- Pull the clips back on the mounting bracket (B) as you lift the lighthead off of the two raised bosses on the bracket, then carefully lift the lighthead out of the lightbar base and disconnect the power cord (C), and remove the lighthead from the lightbar.

**Corner Strobe / Installation:**

- Plug the lighthead into the wiring harness (C).
- Insert the end of the bracket into the 2 bosses, and snap the side of the lighthead into the clips in the bracket (B), then snap the lighthead tab into the corner strobe support bracket (A) and replace the endcap. Reconnect to power.

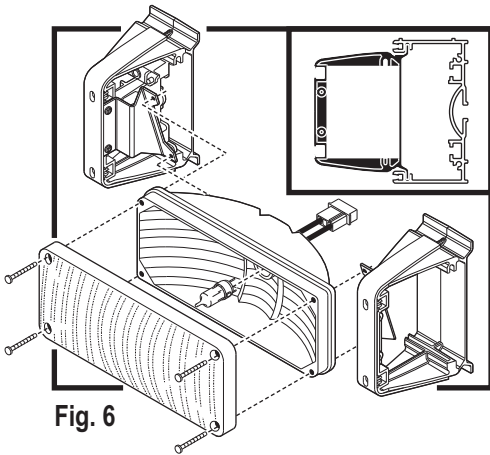
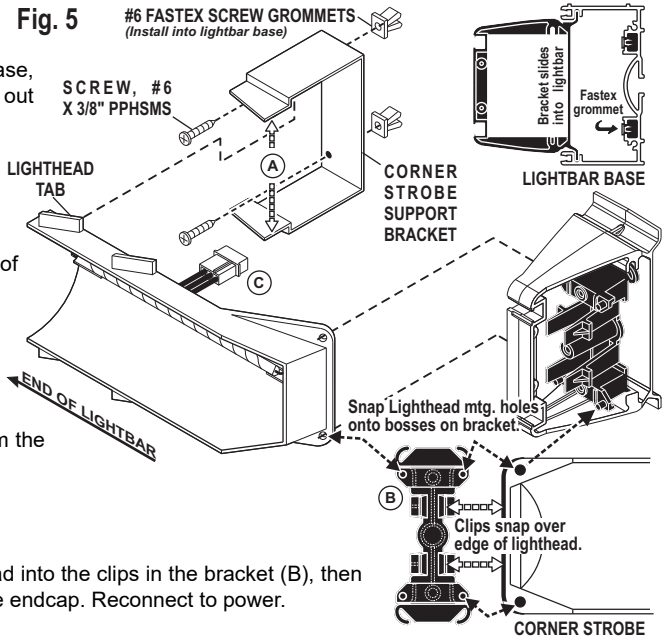

**Halogen Lighthead, Load Light / Rear Facing / Removal:**

- Disconnect the lightbar from its power source and remove the lens and/or endcap in front of the lighthead you wish to service.
- Unscrew the 4 lens screws which hold the lighthead to its 2 brackets (Fig 6).
- Disconnect the lighthead from power, then remove the lighthead from the lightbar.

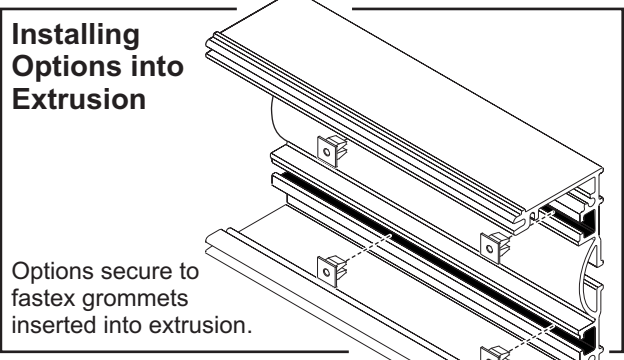

**Halogen Lighthead, Load Light / Rear Facing / Installation:**

- Plug the lighthead's connector into the lightbar harness.
- Attach the lighthead (and lens) to its mounting brackets using the lens screws you removed.
- Replace the lightbar lenses or endcaps and the installation is complete.

**400 Linear Split LED with MR11 Load Light / TA only**

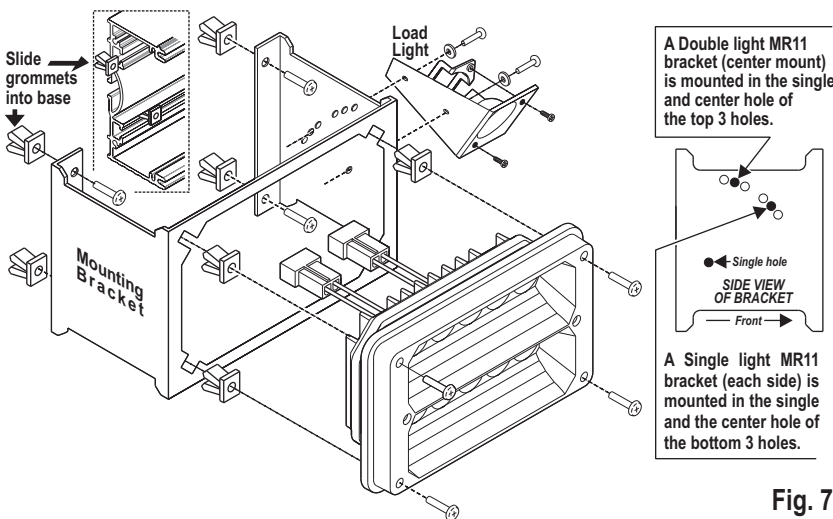

**Halogen, Strobe or LED Lighthead (New style housing)**

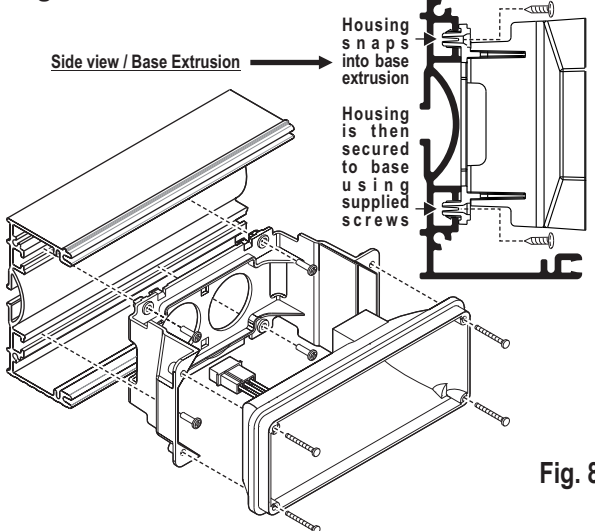
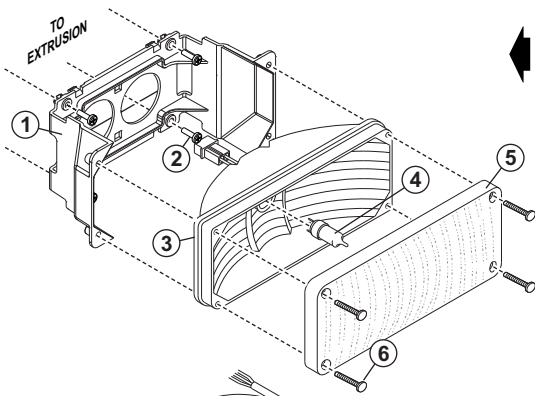

Fig. 7

Fig. 8



**MODEL 45ADDHAL**

QTY	ITEM	PART NUMBER	DESCRIPTION
*		02-0484303-02	700 SERIES HALOGEN
1	1	07-284353-000	BRACKET / MOUNTING
4	2	15-081416-080	SCREW / #8 x 1/2" PPHSMS
1	3	02-0383709-02	700 REFLECT. 2 WIRE-2 POS AMP
1	4	34-0041987-07	12V-60W SNAP-IN-LAMP
1	5	68-1183582-3S	LENS / CLEAR OPTIC
4	6	15-061416-200	SCREW / #6 x 1-1/4" PPHSMS

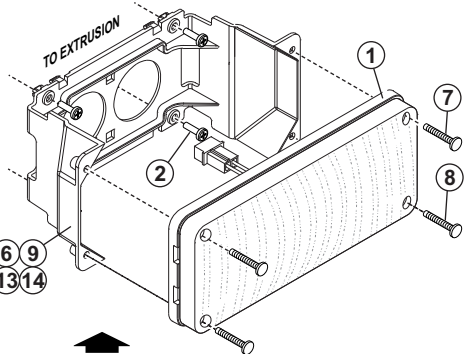

3 4 5 6 9  
10 11 12 13 14

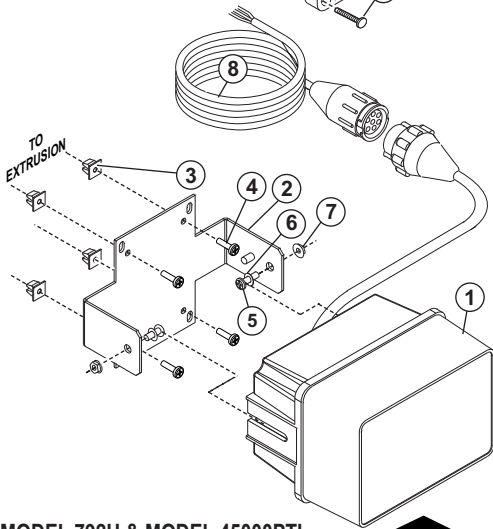

**MODEL 792H & MODEL 45000PTI**

QTY	ITEM	PART NUMBER	DESCRIPTION
*		01-5015970-29	MODEL 792H OPTICOM EMITER
*		01-0417074-00	OPTION / PREWIRE PLUS FOR OPTICOM
-	1	01-5015970-29	MODEL 792H OPTICOM EMITER
1	-	07-263401-000	BRACKET / MOUNTING 792/4500
4	-	13-062C40-16J	SCREW GROMMET / #6/#8 FASTEX
4	-	15-061416-060	SCREW / #6 x 3/8" PPHSMS
2	-	14-104066-100	BOLT / 10-24 X 5/8" CARRIAGE / SS
2	-	16-100220-500	WASHER / #10 FLAT .631 x .060 / THK / SS
2	-	13-104111-063	NUT / 10-24 CAD PLATED WHIZ
1	-	46-0968085-25	ASSY / 3M LC EMIT CABLE / 25' CONXALL

**MODELS: 45ADL8\* / 45ADL8\***

QTY	QTY	QTY	QTY	QTY	QTY	QTY	QTY	QTY	QTY	QTY	ITEM	PART NUMBER	DESCRIPTION
										*		02-0484303-03	700 SERIES LINEAR LED - AMB
										*		02-0484303-04	700 SERIES LINEAR LED - BLU
										*		02-0484303-05	700 SERIES LINEAR LED STDY - WHT
										*		02-0484303-06	700 SERIES LINEAR LED STDY - RED
										*		02-0484303-36	700 SERIES LINEAR LED STDY - GRN
										*		02-0484303-40	700 SERIES LINEAR LED STDY - AMB
										*		02-0484303-41	700 SERIES LINEAR LED STDY - BLU
										*		02-0484303-42	700 SERIES LINEAR LED STDY - WHT
										*		02-0484303-43	700 SERIES LINEAR LED STDY - GRN
										*		02-0484303-44	700 SERIES LINEAR LED STDY - RED
1	1	1	1	1	1	1	1	1	1	1	07-284353-000	BRACKET, MOUNTING	
4	4	4	4	4	4	4	4	4	4	2	15-081416-080	SCREW, #8 x 1/2" PPHSMS	
-	-	-	-	-	-	-	-	-	1	3	01-0286419412	SUB ASSY., 700 LINEARLED - AMB	
-	-	-	-	-	-	-	-	1	-	4	01-0286419422	SUB ASSY., 700 LINEAR LED - BLU	
-	-	-	-	-	-	-	-	1	-	5	01-0286419432	SUB ASSY., 700 LINEAR LED - WHT	
-	-	-	-	-	-	-	-	1	-	6	01-0286419452	SUB ASSY., 700 LINEAR LED - RED	
4	4	4	4	4	4	4	4	4	4	8	15-061416-200	SCREW, #6 x 1-1/4" PPHSMS	
-	-	-	-	-	-	-	-	1	-	9	01-0286419442	SUB ASSY., 700 LINEAR LED - GRN	
-	-	-	-	-	-	-	-	1	-	10	01-0286419213	SUB ASSY., 700 LIN LED STDY - AMB	
-	-	-	-	-	-	-	-	1	-	11	01-0286419223	SUB ASSY., 700 LIN LED STDY - BLU	
-	-	-	-	-	-	-	-	1	-	12	01-0286419233	SUB ASSY., 700 LIN LED STDY - WHT	
-	-	-	-	-	-	-	-	1	-	13	01-0286419243	SUB ASSY., 700 LIN LED STDY - GRN	
-	-	-	-	-	-	-	-	1	-	14	01-0286419253	SUB ASSY., 700 LIN LED STDY - RED	

**MODEL 45ADDAST**

QTY	ITEM	PART NUMBER	DESCRIPTION
*		02-0484303-16	ASSY. / CORNER LINEAR STROBE
2	1	13-062C40-16J	SCREW GROMMET
1	2	07-26C091-000	BRACKET / CORNER STROBE
2	3	15-061416-060	SCREW / #6 x 3/8" PPHSMS
1	4	46-0941245-00	HARNES ASSY. / STROBE
1	5	02-0342933-00	SUB ASSY. / MOUNTING BRACKET
1	6	07-263103-000	BRACKET / LIGHTHEAD MOUNTING
1	7	02-0363171-00	ASSY. / CORNER LINEAR STROBE
1	8	26-0215001-03	TY WRAP - 3"
1	9	01-0440624-25	CABLE ASSEMBLY - 25'

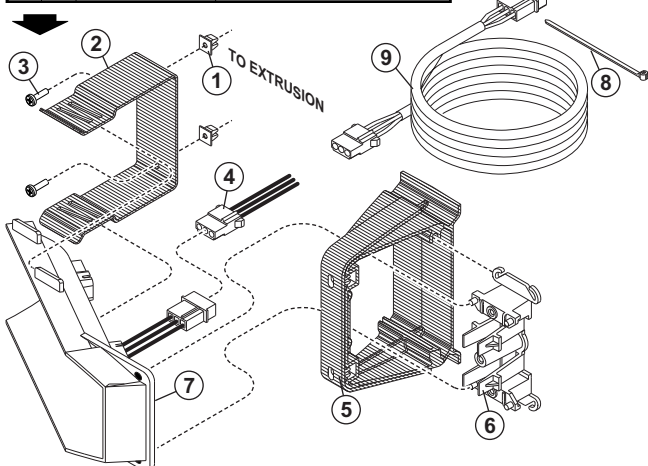

**MODEL 45ADROTA**

QTY	ITEM	PART NUMBER	DESCRIPTION
*		02-0484303-01	ROTATOR
1	1	02-0342945-00	ROTATING REFLECTOR
1	2	02-0342949-00	HALF MIRROR RIGHT
1	3	02-0342949-01	HALF MIRROR LEFT
1	4	68-5943171-01	TAPE / METALIZED
A/R	5	68-5463532-00	"V" MIRROR BRACKET

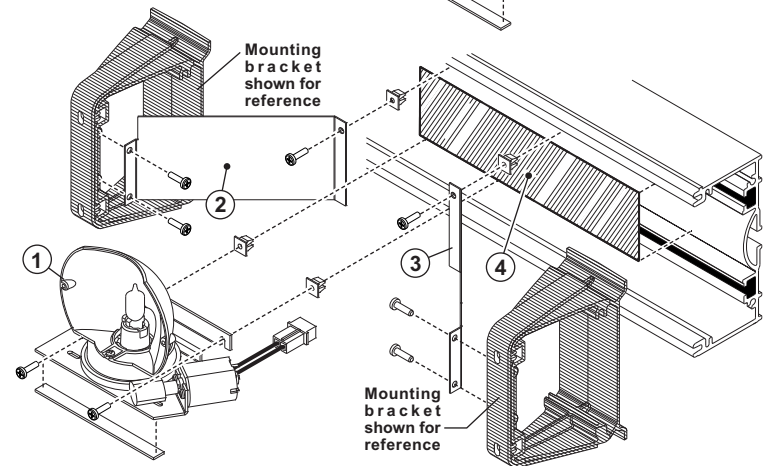
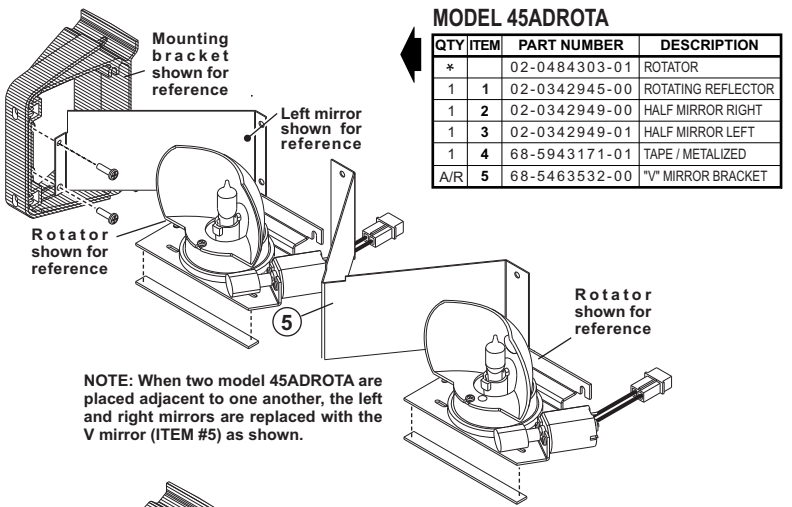

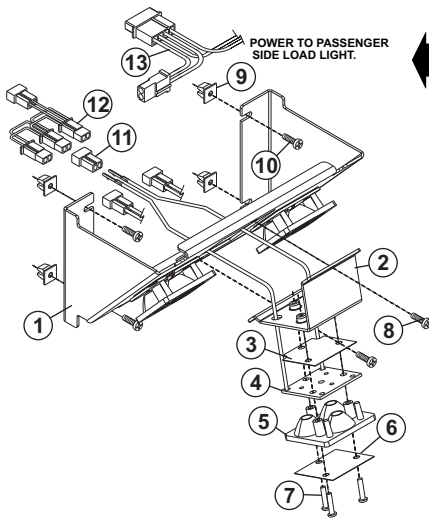

**MODEL: 45LRLOAD**

QTY	QTY	ITEM	PART NUMBER	DESCRIPTION
*	*		02-0484303-48	LR11 LOAD LIGHT OPTION
*			02-0484303-50	LR11 LOAD LIGHT W/O INPUT HARNESS
2	2	1	07-286741-000	BRACKET, MTG LR11 LOAD LT DBL 4500
2	2	2	07-26C834-000	BRACKET, MTG LR11 LOAD LT SNGL 4500
6	6	3	56-043625-000	THERMAL PAD, CO-THERM LR11
6	6	4	02-016B644-30	PCB 3 LED LR11 WHT ALLEY/TD XP-E
6	6	5	68-5944082-31	REFLECTOR, TIR LR11 LOAD LIGHT 4500
6	6	6	68-7744081-00	DIFFUSER, LR11 LOAD LIGHT 4500 SERIES
18	18	7	14-062216-160	SCREW, 6-32 X 1" PPHMS SS
4	4	8	14-062216-061	SCREW, 6-32 X 3/8 PPHMS SEMS WIT LK WSHR SS
8	8	9	13-062C40-16J	SCREW GROMMET, #6/#8 FASTEX
8	8	10	15-061416-060	SCREW, 6 X 3/8 PPHMS 410 SS TYPE A
6	6	11	39-0402313-04	HOUSING, 2 POS PIN COMM MATE-N-LOK
2	2	12	46-0744083-00	ASSY, HARNESS LR11 LOAD LIGHT 4500
*	1	13	46-0941243-00	ASSY, SCENE LIGHT HARNESS

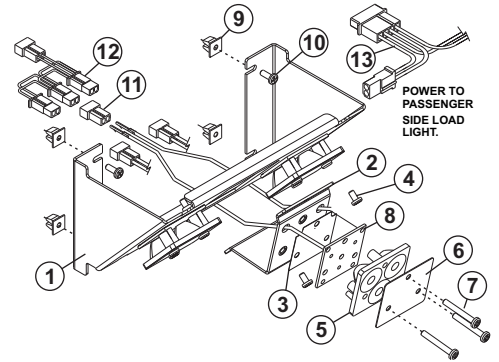

**MODEL: 45LRLOAD / 13 DEGREE**

QTY	ITEM	PART NUMBER	DESCRIPTION
*	*	02-0484303-51	LR11 LOAD LT OPT. 13 DEGREE
2	1	07-286741-000	BRKT, MTG LR11 LOAD LT DBL 4500
2	2	07-26C834-000	BRKT, MTG LR11 LOAD LT SNGL 4500
6	3	56-043625-000	THERMAL PAD, CO-THERM LR11
6	4	02-016B644-30	PCB 3 LED LR11 WHT ALLEY/TAKEDON XP-E
6	5	68-5944082-31	REFLECTOR, TIR LR11 LOAD LT 4500
6	6	68-7744081-00	DIFFUSER, LR11 LOAD LT 4500 SERIES
18	7	14-062216-160	SCREW, 6-32 X 1" PPHMS SS
4	8	14-062216-061	SCREW, 6-32 X 3/8 PPHMS SEMS WIT LOCK WSHR SS
8	9	13-062C40-16J	SCREW GROMMET, #6/#8 FASTEX
8	10	15-061416-060	SCREW, 6 X 3/8 PPHMS 410 SS TYPE A
6	11	39-0402313-04	HSNG, 2 POS PIN COMM MATE-N-LOK
2	12	46-0744083-00	HARNESS LR11 LOAD LIGHT 4500
1	13	46-0941243-00	ASSY, SCENE LIGHT HARNESS

**MODEL 45ADDSTR**

QTY	ITEM	PART NUMBER	DESCRIPTION
*	*	02-0484303-07	700 SERIES LINEAR STROBE
1	1	02-0362641-00	700 LINEAR REFLECTOR
A/R	2	46-0941245-00	HARNESS ASSY., STROBE
1	3	07-284353-000	BRACKET, MOUNTING
4	4	15-081416-080	SCREW, #8 x 1/2" PPHMS
4	5	15-061416-160	SCREW, #6 x 1" PPHMS
1	6	01-0440624-25	CABLE ASSEMBLY - 25'
A/R	7	46-0941248-00	HARNESS STROBE CTR

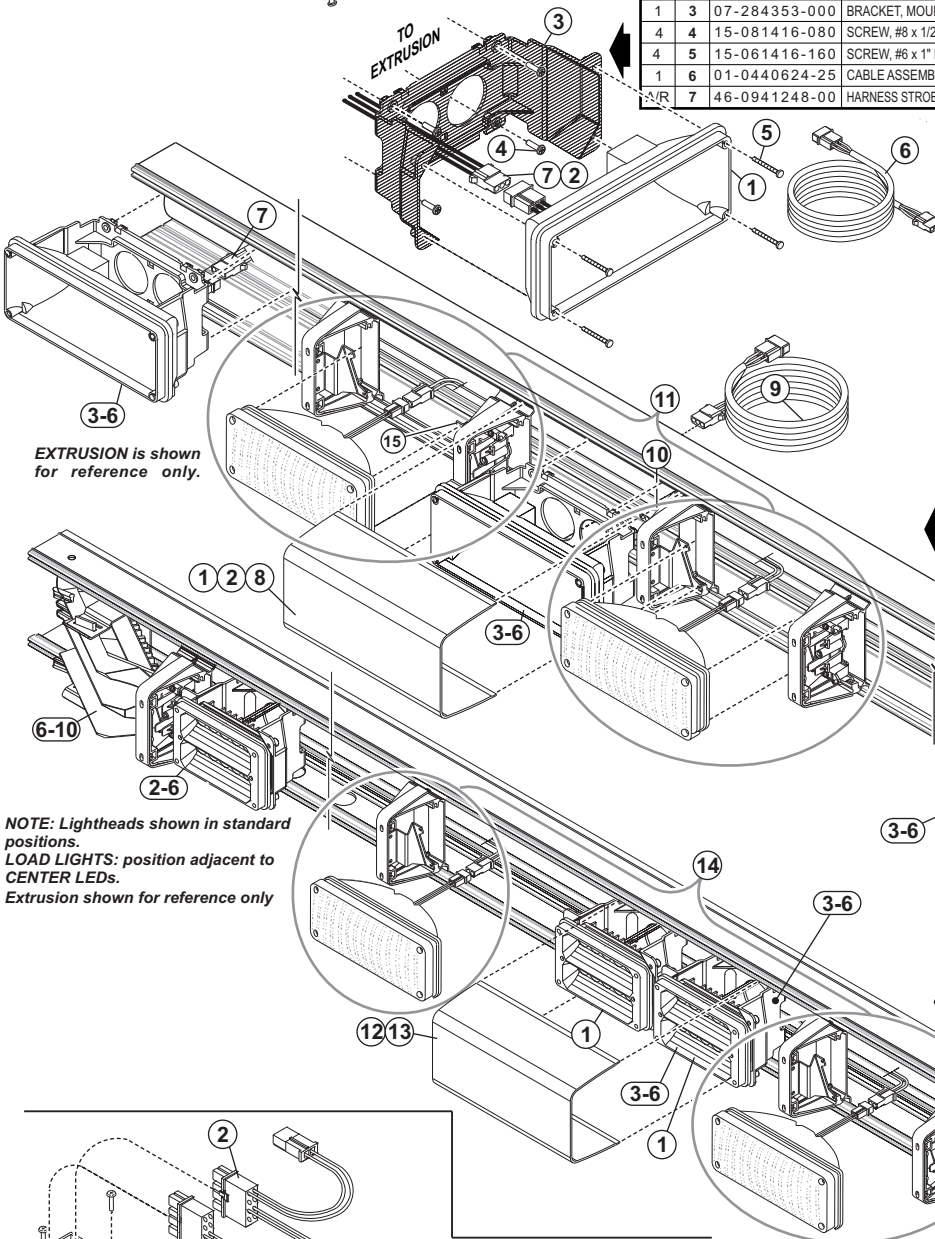

**MODEL 45KRS**

QTY	ITEM	PART NUMBER	DESCRIPTION
*	*	02-0484303-15	OPTION / KKK REAR STROBE PKG. 4500 SERIES
-2	1	68-3983799-50	LENS / RED NON OPTIC 16.57 / 4500 SERIES
1	2	68-3983799-30	LENS / CLEAR NON OPTIC 16.57 / 4500 SERIES
3	3	02-0362641-00	ASSY / 700 LINEAR REFLECTOR
3	4	07-284353-000	BRACKET / MOUNTING
12	5	15-081416-080	SCREW / #8 x 1/2" PPHMS
12	6	15-061416-160	SCREW / #6 x 1" PPHMS
2	7	46-0941245-00	HARNESS ASSY. / STROBE
1	8	68-3983799-10	LENS / AMBER NON OPTIC 16.57 / 4500 SERIES
3	9	01-0440624-25	CABLE ASSEMBLY - 25'
1	10	46-0941248-00	HARNESS ASSY / STROBE CENTER
1	11	02-0483910-00	SUB ASSY / LOAD LIGHT 4500 SERIES

**MODEL: 45KRL**

QTY	ITEM	PART NUMBER	DESCRIPTION
*	*	02-0484303-18	OPTION / KKK REAR LED PACKAGE
2	1	01-0286361211	SUB ASSY, 400 LINEAR LED SPLIT / AMB/AMB
2	2	01-0286361255	SUB ASSY, 400 LINEAR LED SPLIT / RED/RED
16	3	15-061416-160	SCREW, 6X1 PPHMS TYPE A
4	4	46-0784112-04	UPPER LED ADAPTER
4	5	07-284354-000	BRACKET, MTG 400 SERIES LIGHthead
8	6	15-081416-080	SCREW, 8 X 1/2 PPHMS
4	7	13-062C40-16J	SCREW GROMMET, #6/#8 FASTEX
2	8	01-026B807-50	ASSY CORNER LED RED AMP/4500 SERIES
2	9	07-263579-000	BRACKET, SUPPORT CORNER STROBE
2	10	02-0342934-00	SUB ASSY, BRACKET & BASE
4	11	15-061416-060	SCREW, 6 X 3/8 PPHMS 410 SS TYPE A
-1	12	68-3983799-50	LENS, RED NON OPTIC 16.57/4500 SERIES
1	13	68-3983799-10	LENS, AMBER NON OPTIC 16.57/4500 SERIES
1	14	02-0483910-00	SUB ASSY, LOAD LIGHTS /4500 SERIES

**MODEL: 45FLASH**

QTY	ITEM	PART NUMBER	DESCRIPTION
*	*	02-0484303-32	4500 OPTION / ADD INTERNAL FLASHER
1	1	02-0343046-00	ASSY / 2 CHANNEL FLASHER / 4500 SERIES LED
1	2	46-0764668-00	ASSY / HARNESS / 400 LED with FLASHER
1	3	46-0743203-00	ASSY / FLASHER INPUT HARNESS

**MODEL 45KFH**

QTY	ITEM	PART NUMBER	DESCRIPTION
*	1	02-0484303-120	KKK FRONT HALOGEN PKG. 4500 SERIES
-1	1	68-3983799-50	LENS / RED NON OPTIC 16.57 / 4500 SERIES
1	2	68-3983799-30	LENS / CLEAR NON OPTIC 16.57 / 4500 SERIES
3	3	68-1183582-3S	LENS / CLEAR OPTIC
3	4	34-0041987-07	ASSY. / 12V-60W SNAP-INL-AMP
12	5	15-081416-080	SCREW / #8 x 1/2" PPHSMS
3	7	07-284353-000	BRACKET / MOUNTING
3	8	02-0383709-02	ASSY. / 700 REFLECTOR 2 WIRE/2 POS AMP

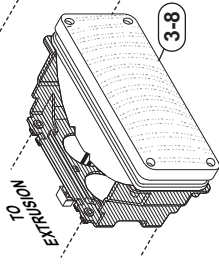

**MODEL 45KRH**

QTY	ITEM	PART NUMBER	DESCRIPTION
2	1	68-3983799-50	LENS / RED NON OPTIC 16.57 / 4500 SER.
1	2	68-3983799-30	LENS / CLR NON OPTIC 16.57 / 4500 SER.
3	3	07-284353-000	BRACKET / MOUNTING
3	4	68-1183582-3S	LENS / CLEAR OPTIC
3	5	34-0041987-07	ASSY. / 12V60W SNAP-INL-AMP
12	6	15-081416-080	SCREW / #8 x 1/2" PPHSMS
12	7	15-061416-200	SCREW / #6 x 1 1/4" PPHSMS
3	8	02-0383709-02	700 REFLECTOR 2 WIRE / 2 POS AMP
1	9	68-3983799-10	LENS / AMB NON OPTIC 16.57 / 4500 SER.
1	10	02-0483910-00	SUB ASSY / LOAD LIGHTS / 4500 SER.

NOTE: Lightheads shown in standard positions.  
Position Load Lights adjacent to center halogen.

**CUSTOMERS WIRING (OPTIONAL) HARNESS**

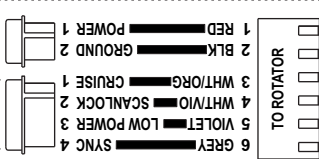

**MODEL 45ADR\***

QTY	ITEM	PART NUMBER	DESCRIPTION
*	1	02-0484303-0	4500 SOLID STATE ROTATOR
1	1	01-026E607-0	SOLID STATE ROTATOR
4	2	13-062C40-16J	SCREW GROMMET
4	3	15-061416-060	SCREW #6 x 3/8" PPHSMS

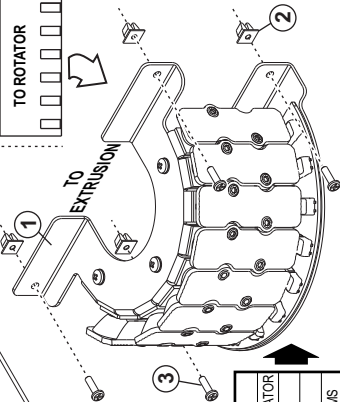

**MODEL 45KFL\***

QTY	ITEM	PART NUMBER	DESCRIPTION
*	1	02-0484303-27	400 LINEAR LED AMB AMP
*	2	02-0484303-28	400 LINEAR LED BLU AMP
*	3	02-0484303-29	400 LINEAR LED WHT AMP
*	4	02-0484303-30	400 LINEAR LED GRN AMP
*	5	02-0484303-31	400 LINEAR LED RED AMP
4	4	15-061416-160	6 X 1 PPHSMS TYPE "A"
2	2	15-081416-080	8 X 1/2 PPHSMS
1	1	07-284354-000	BRACKET / MTG 400 LTHD
1	1	46-0784112-04	HARNES / UPPER LED ADAPT.
-	-	01-0386361211	S. ASY / 400 LED SPLIT AMB-AMB
-	-	01-0386361222	S. ASY / 400 LED SPLIT BLU-BLU
-	-	01-0386361233	S. ASY / 400 LED SPLIT WHT-WHT
-	-	01-0386361244	S. ASY / 400 LED SPLIT GRN-GRN
1	9	01-0386361255	S. ASY / 400 LED SPLIT RED-RED

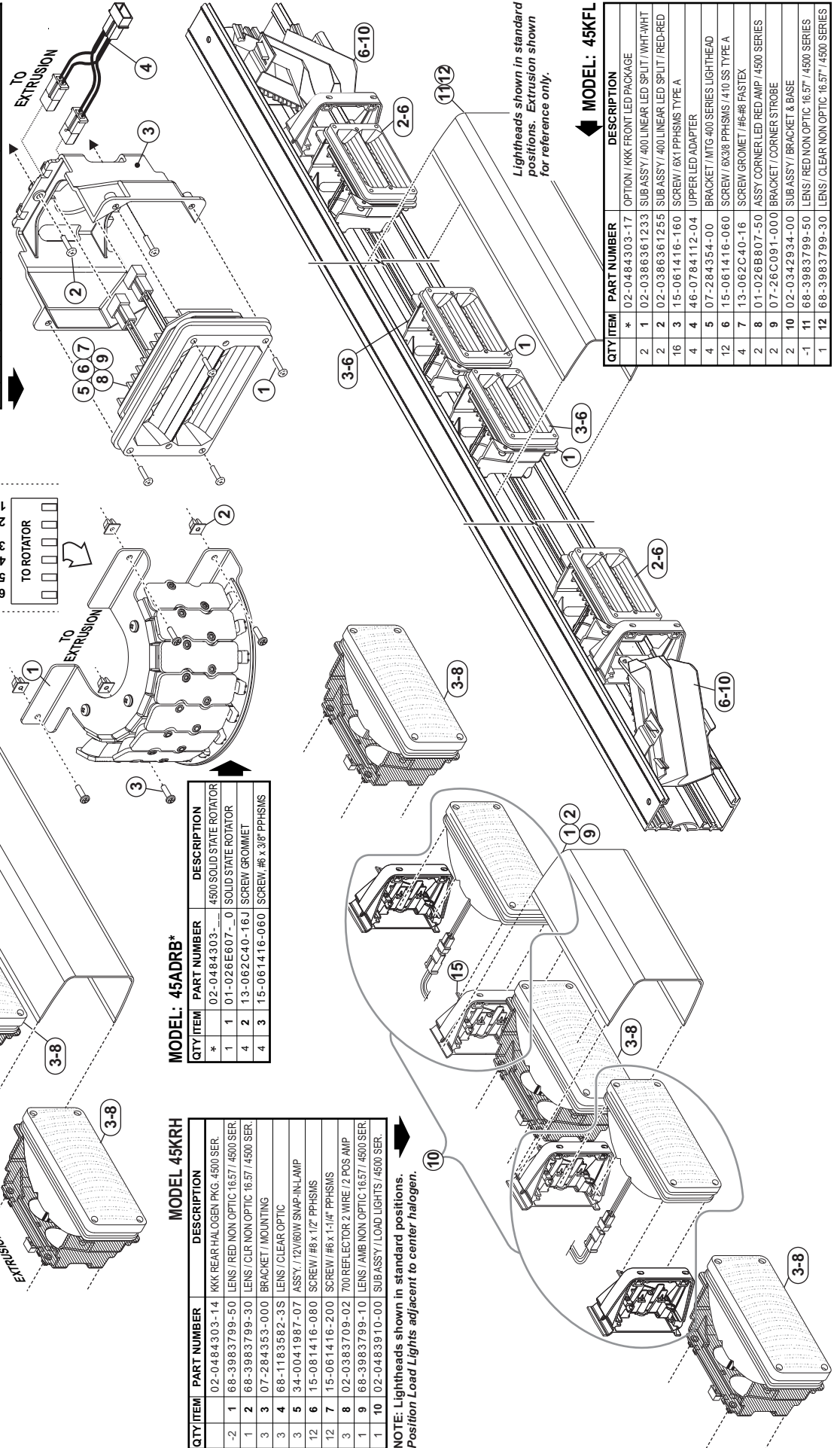

Lightheads shown in standard positions. Extrusion shown for reference only.

**MODEL: 45KFL**

QTY	ITEM	PART NUMBER	DESCRIPTION
*	1	02-0484303-17	OPTION / KKK FRONT LED PACKAGE
2	1	02-0386361233	SUB ASSY / 400 LINEAR LED SPLIT / WHT-WHT
2	2	02-0386361255	SUB ASSY / 400 LINEAR LED SPLIT / RED-RED
16	3	15-061416-160	SCREW / 6X1 PPHSMS TYPE A
4	4	46-0784112-04	UPPER LED ADAPTER
4	5	07-284354-00	BRACKET / MTG 400 SERIES LIGHTHEAD
12	6	15-061416-060	SCREW / 6X3/8 PPHSMS / 410 SS TYPE A
4	7	13-062C40-16	SCREW GROMMET / #6-#6 FASTEX
2	8	01-026B807-50	ASSY CORNER LED RED AMP / 4500 SERIES
2	9	07-26C091-000	BRACKET / CORNER STROBE
2	10	02-0342934-00	SUB ASSY / BRACKET & BASE
-1	11	68-3983799-50	LENS / RED NON OPTIC 16.57 / 4500 SERIES
1	12	68-3983799-30	LENS / CLEAR NON OPTIC 16.57 / 4500 SERIES

**MODELS: 45TA6 / 45TA8**

QTY	QTY	ITEM	PART NUMBER	DESCRIPTION
	*		02-0484303-33	6 LAMP TA / 4500 SERIES
	*		02-0484303-34	8 LAMP TA / 4500 SERIES
1	1	1	46-0784545-00	4500 INTERNAL HARNESS / TA
1	1	2	01-0683850-00	TA CONTROL HEAD 12V LED
1	1	3	46-0741346-35	CABLE ASSY / 9-C 35' 4" STRIP
2	2	4	39-0412014-14	HOUSING / AMP 12 POS. PIN
32	24	5	15-061416-160	SCREW / #6 X 1" PPHSMS
8	6	6	01-0386361211	SUB ASY / 400 LED SPLIT AMB-AMB
8	6	7	07-284354-000	MOUNTING BRKT. 400 .LTHD
16	12	8	15-081416-080	SCREW / #8 X 1/2" PPHSMS
8	6	9	46-0784112-04	Y HARNESS 6" ASSEMBLY
1	1	10	16-1766430-08	WASHER 1/2" I.D.
1	1	11	26-0121053-00	CLAMP 3/8"

EXTRUSION, CORNER LEDs and CENTER LENS are shown for reference only.

NOTE: Model 45TA8 shown. For Model 45TA6 drop out the center two lighthoods.

**MODEL 45KFS**

QTY	ITEM	PART NUMBER	DESCRIPTION
*		02-0484303-13	KKK FRONT STROBE PKG. 4500 SERIES
-1	1	68-3983799-50	LENS / RED NON OPTIC 16.57 / 4500 SERIES
1	2	68-3983799-30	LENS / CLEAR NON OPTIC 16.57 / 4500 SERIES
3	3	02-0362641-00	ASSY / 700 LINEAR REFLECTOR
3	4	07-284353-000	BRACKET / MOUNTING
12	5	15-081416-080	SCREW / #8 X 1/2" PPHSMS
12	6	15-061416-160	SCREW / #6 X 1" PPHSMS
2	7	46-0941245-00	HARNESS ASSY / STROBE
3	8	01-0440624-25	CABLE ASSEMBLY - 25'
1	9	46-0941248-00	HARNESS ASSY / STROBE CENTER

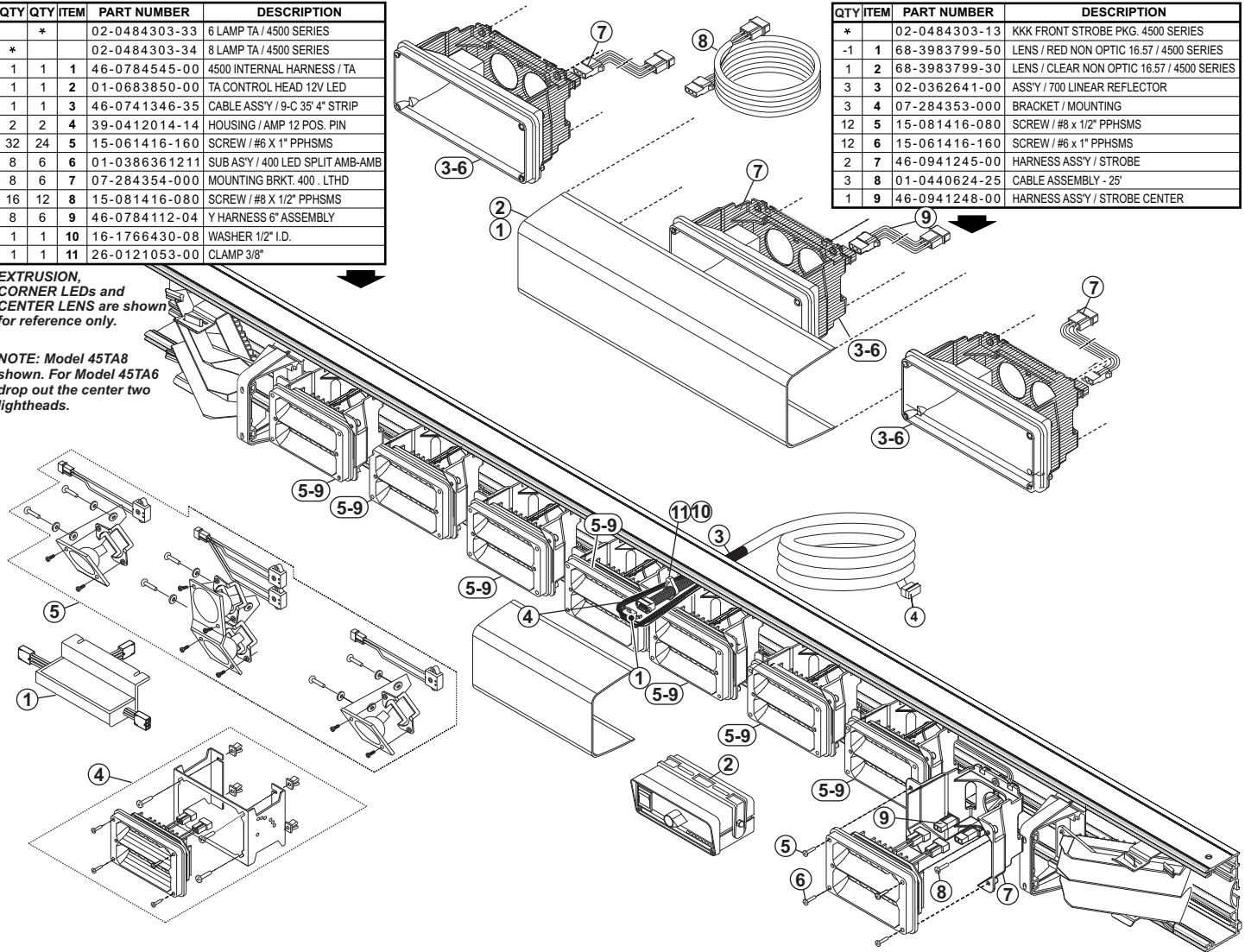

**MODEL: 45TA with MR11 Load Lights**

QTY	PART NUMBER	DESCRIPTION
*	02-0484303-35	MODEL 45TA / MR11 LOAD LTS
1	01-0269809-06	4500 T/A FLASHER 6 LAMP
1	01-0669813-00	TADCTL1 CTRLHD / DOMINATOR TA
2	02-0342933-00	SUB ASY / MOUNTING BRACKET
6	02-0386361211	400 LIN. LED SPLIT AMB-AMB
1	02-0463931-00	MR11 LOAD LTS / 4500 SERIES
1	46-0743112-00	HARNESS MR11 LOAD LIGHTS
1	46-0743119-00	CABLE T/A OPTION
1	46-0769810-05	HARNESS 4500 TA6 / DBL / RED-ORG-YEL
1	46-0769810-06	HARNESS 4500 TA6 / DBL / VIO-BLU-GRN

**TRAFFIC ADVISOR OPTION W/MR-11 LOAD LIGHTS**

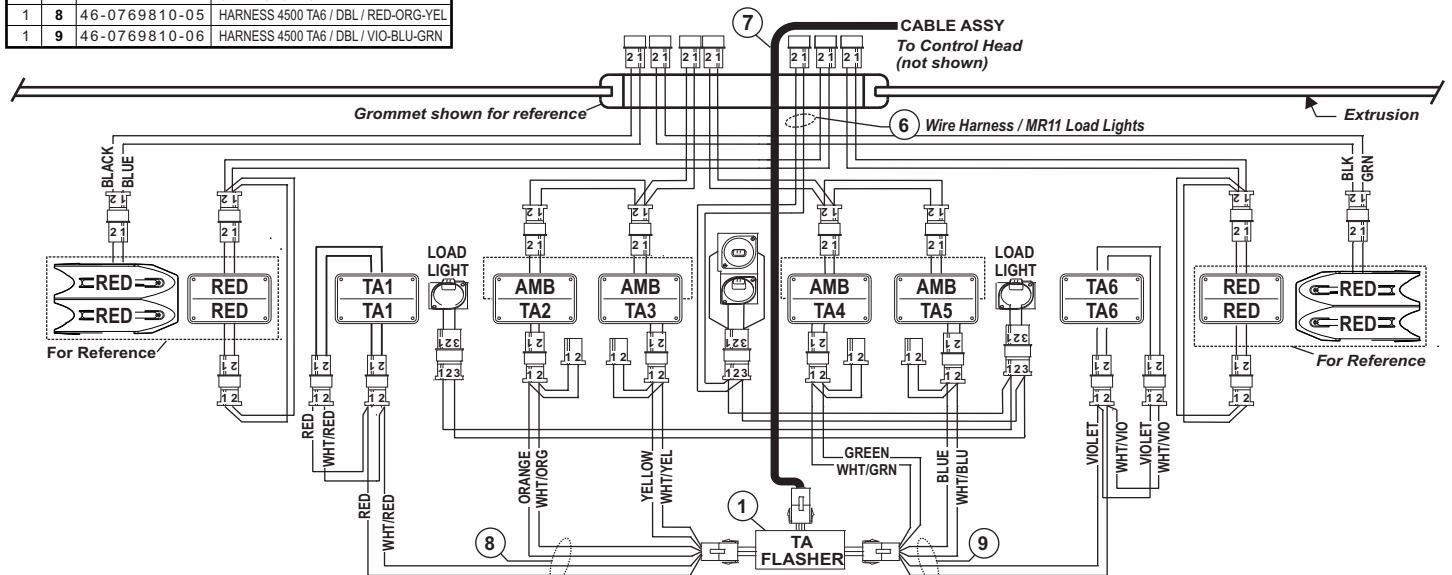
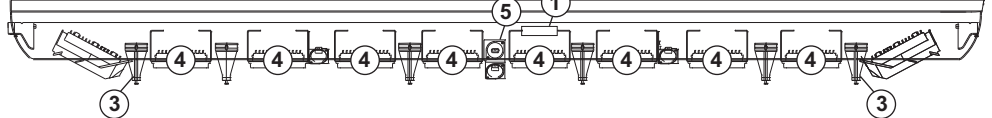

**4500 SERIES WIRING**

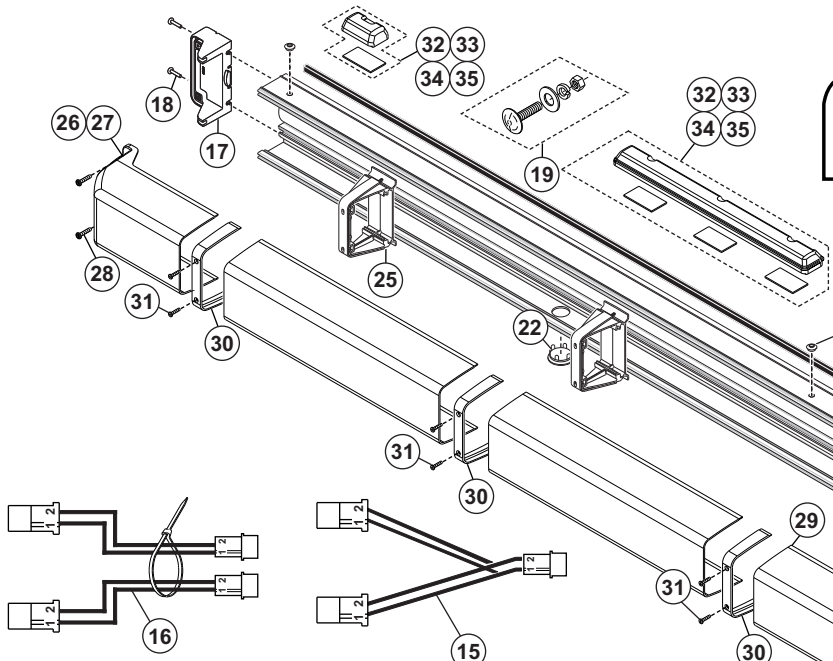
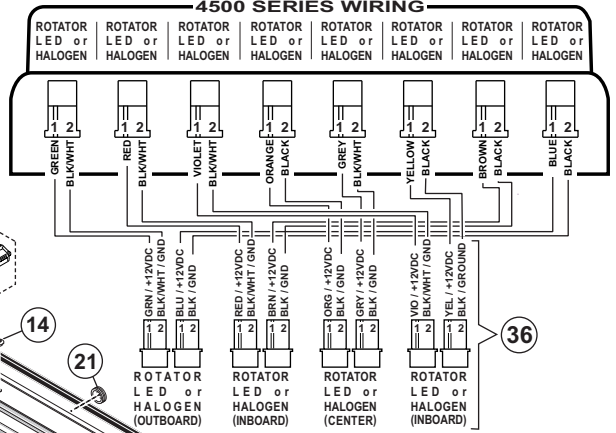

QTY	QTY	QTY	QTY	QTY	QTY	QTY	QTY	QTY	QTY	QTY	QTY	QTY	QTY	QTY	ITEM	PART NUMBER	DESCRIPTION
														*		01-0684303122	4500 SERIES LT BAR-22" without ICC LT.
														*		01-0684303138	4500 SERIES LT BAR-38" without ICC LT.
														*		01-0684303144	4500 SERIES LT BAR-44" without ICC LT.
														*		01-0684303_52	4500 SERIES LT BAR-52" / See P/N Key
														*		01-0684303_60	4500 SERIES LT BAR-60" / See P/N Key
														*		01-0684303_72	4500 SERIES LT BAR-72" / See P/N Key
														*		01-0684303_76	4500 SERIES LT BAR-76" / See P/N Key
														*		01-0684303_82	4500 SERIES LT BAR-82" / See P/N Key
														*		01-0684303_84	4500 SERIES LT BAR-84" / See P/N Key
														*		01-0684303_86	4500 SERIES LT BAR-86" / See P/N Key
														*		01-0684303_88	4500 SERIES LT BAR-88" / See P/N Key
														*		01-0684303_90	4500 SERIES LT BAR-90" / See P/N Key
														*		01-0684303_94	4500 SERIES LT BAR-94" / See P/N Key
														*		01-0684303_92	4500 SERIES LT BAR-92" / See P/N Key
														1	1	11-463582-100	EXTRUSION, 17.31" without ICC MTG. HOLES
														2	2	11-463582-106	EXTRUSION, 33.67" without ICC MTG. HOLES
														3	3	11-463582-109	EXTRUSION, 39.67" without ICC MTG. HOLES
														4	4	11-463582-001	EXTRUSION, 47.67" with ICC MTG. HOLES
														5	5	11-463582-016	EXTRUSION, 55.67" with ICC MTG. HOLES
														6	6	11-463582-002	EXTRUSION, 67.67" with ICC MTG. HOLES
														7	7	11-463582-023	EXTRUSION, 71.67" with ICC MTG. HOLES
														8	8	11-463582-003	EXTRUSION, 77.67" with ICC MTG. HOLES
														9	9	11-463582-005	EXTRUSION, 79.67" with ICC MTG. HOLES
														10	10	11-463582-026	EXTRUSION, 81.67" with ICC MTG. HOLES
														11	11	11-463582-027	EXTRUSION, 83.67" with ICC MTG. HOLES
														12	12	11-463582-028	EXTRUSION, 85.67" with ICC MTG. HOLES
														13	13	11-463582-030	EXTRUSION, 89.67" with ICC MTG. HOLES
A/R	A/R	A/R	A/R	A/R	A/R	A/R	A/R	A/R	A/R	A/R	A/R	A/R	A/R	A/R	14	21-3117552-00	HOLE PLUG, 9.65MM GROOVE DIA./RUBBER BLK
															15	46-0941569-00	ASSY, CENTER ROTATORS, HARNESS
														2	2	46-0941244-00	ASSY, ROTATORS HARNESS
2	2	2	2	2	2	2	2	2	2	2	2	2	2	2	17	02-0342932-00	MOUNTING BASE ASSEMBLY
4	4	4	4	4	4	4	4	4	4	4	4	4	4	4	18	14-104286-16J	SCREW, #10-24 x 1.25" SHOULDER PHTX TRI PT
4	4	4	4	4	4	4	4	4	4	4	4	4	4	2	19	01-0441771-00	KIT, EXTRUSION STEP BOLT MTG. 1-1/4"
1	1	1	1	1	1	1	1	1	1	1	1	1	1	1	20	10-0522977-01	LABEL, P/N/M/N/S/N
1	1	1	1	1	1	1	1	1	1	1	1	1	1	1	21	21-11263204-0	GROMMET, 1" SLIM LINE
2	2	2	2	2	2	2	2	2	2	2	2	2	2	2	22	02-0320397-00	LOUVER, 1" W/FILTER
14.6	114.94	14.27	13.94	13.6	13.28	12.95	11.95	11.28	9.28	7.94	6.61	5.61	2.88	23	38-0316275-00	GASKET, REAR EXTRUSION	
16.13	16.46	15.79	15.46	15.13	14.80	14.47	13.47	12.80	10.80	9.46	8.13	7.13	4.44	24	38-0522954-00	SEAL, CORD 3/16"	
8	8	8	8	6	6	6	6	6	5	3	3	3	1	25	02-0342933-00	MOUNTING BRACKET ASSEMBLY	
2	2	2	2	2	2	2	2	2	2	2	2	2	2	26	68-3983813-**	LENSCAP	
A/R	A/R	A/R	A/R	A/R	A/R	A/R	A/R	A/R	A/R	A/R	A/R	A/R	A/R	27	68-3963615-**	LENSCAP, SPLIT	
4	4	4	4	4	4	4	4	4	4	4	4	4	4	28	15-06121B-082	SCREW, #6 x 1/2" PPHSMS (BLACK)	
7	7	7	7	5	5	5	5	5	4	2	2	2	-	29	68-3983799-**	LENS	
8	8	8	8	6	6	6	6	6	5	3	3	3	1	30	02-0342941-00	ASSY / LENS GASKET/RETAINER	
16	16	16	16	12	12	12	12	12	10	6	6	6	2	31	15-08121B-082	SCREW / #8 x 1/2" PPHSMS / BLACK	
A/R	A/R	A/R	A/R	A/R	A/R	A/R	A/R	A/R	A/R	A/R	A/R	A/R	A/R	32	02-0483903-A0	ASSY / LED ICC LIGHTS - AMBER	
A/R	A/R	A/R	A/R	A/R	A/R	A/R	A/R	A/R	A/R	A/R	A/R	A/R	A/R	33	02-0483903-R0	ASSY / LED ICC / BRAKE LIGHTS - RED	
-	-	-	-	-	-	-	-	-	-	-	-	-	-	34	02-0483903CA0	ASSY / CTR LED ICC LIGHTS - AMBER	
-	-	-	-	-	-	-	-	-	-	-	-	-	-	35	02-0483903CR0	ASSY / CTR LED ICC / BRAKE LTS - RED	
1	1	1	1	1	1	1	1	1	1	1	1	1	1	36	46-0764014-00	ASSY / HARNESS	
1	-	-	-	-	-	-	-	-	-	-	-	-	-	37	11-463582-029	EXTRUSION, 87.67" WITH ICC MTG. HOLES	

**OPTION GTT EMITTER**

QTY	ITEM	PART NUMBER	DESCRIPTION
*		02-0484303-39	GTT LED EMITTER
REF	1	01-1317921-01	EMITTER, LED GTT
4	2	15-061416-060	SCREW, #6 X 3/8" PPHSMS
1	3	07-26B390-023	MTG BRKT GTT LED MODULE
4	4	15-045216-060	SCREW, 4 X 3/8" PFH PLASTI-LOC
4	5	13-062C40-16J	SCREW GROMET, #6 / #8 FASTEX
1	6	46-0743825-25	CABLE GTT LED EMITTER 25'

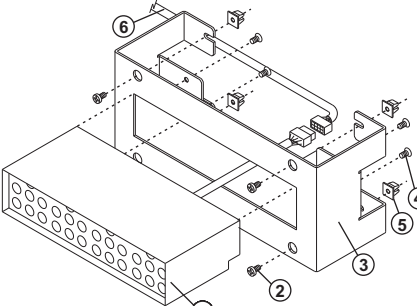

**NOTE:** 52", 60" & 72" Lightbars available without ICC Lights or with Center ICC Lights only (RED or AMBER)

**PART NUMBER KEY:**

**01-0684303** Length of Lightbar  
**ICC Light Requirements**

**ICC LIGHT REQUIREMENTS**  
**1 = Without ICC Lights A = With AMB ICC Lights**  
**R = With RED ICC Lights**

**IMPORTANT WARNING!**  
**CAUTION! DO NOT LOOK DIRECTLY AT THESE LED'S WHILE THEY ARE ON. MOMENTARY BLINDNESS AND/OR EYE DAMAGE COULD RESULT!**

**MODEL TA45B72**

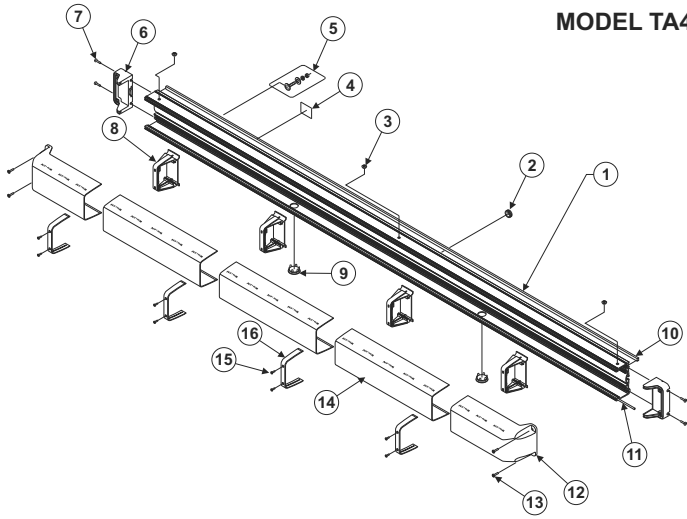

**Note: Optional, non-Standard length cables are not for use with Sequence to Solid or Sequence On/Off flash patterns.**

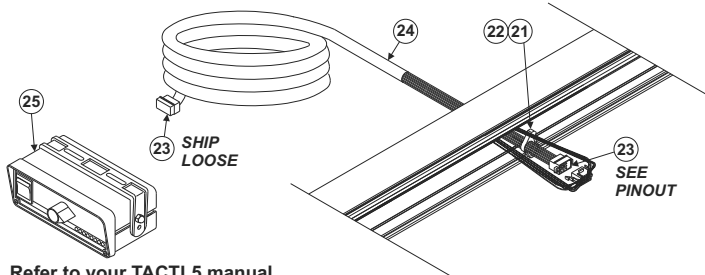

Refer to your TACTL5 manual for detailed information on installation and operation.

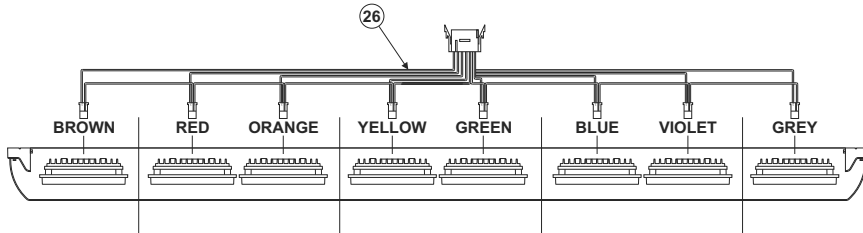

QTY.	ITEM	PART NUMBER	DESCRIPTION
X	X	01-0688243-00	FINAL ASSY, 4500 TA, 700 SERIES LIGHTHEADS, 72"
1	1	11-463582-002	BASE, EXTRUSION MACHINED 67.60 4500 SERIES
1	2	21-11263204-0	GROMMET, 1" SLIM LINE
3	3	21-3117552-00	HOLE PLUG
1	4	10-0522977-01	LABEL, P/N/M/N/S/N 4500 PLUS SERIES
2*	5	01-0441771-00	KIT, EXTRUSION STEP BOLT MT 1 1/4"
2	6	02-0342932-00	SUB ASSY, MOUNTING BASE 4500 SERIES
4	7	14-104286-16J	SCREW, 10-24 X 1.25"
4	8	02-0342933-00	SUB ASSY, MOUNTING BRACKET 4500 SERIES
2	9	02-0320397-00	LOUVER, 1.0" W/ FILTER
11.28	10	38-0316275-00	GASKET
12.80	11	38-0522954-00	SEAL, CORD 3/16 DIA 4500 SERIES
2	12	68-3983813-10	LENSCAP, AMBER NON OPTIC 4500 SERIES
4	13	15-06121B-082	SCREW, 6 X 1/2 PPHSMS
3	14	68-3983799-10	LENS, AMBER NON OPTIC 16.57" 4500 SERIES
8	15	15-08121B-082	SCREW, 8 X 1/2 PPHSMS
4	16	02-0342941-00	ASSY, LENS GASKET/RETAINER 4500 SERIES
32	17	15-061416-200	SCREW, 6 X 1 1/4 PPHSMS
8	18	01-0286419213	SUB ASSY 700 LINEAR TIR STEADY AMB/CLR 2 AMP
32	19	15-081416-080	SCREW, 8 X 1/2 PPHSMS
8	20	07-284353-000	BRACKET, MOUNTING 700 LTHEAD 4500 SERIES
1	21	16-1766430-08	WASHER, 1/2" ID
1	22	26-0121053-00	CLAMP, 3/8" NATURAL
2**	23	39-0412014-14	HOUSING, 12 POS PIN
1	24	46-0741346-35	ASSY, 9/C 35' CABLE
1*	25	01-0688086-00	ASSY, FINAL TACTL5 CONTROL HD
1	26	46-0784545-00	ASSY, HARNESS INTERNAL 4500 TRAFFIC ADVISOR

\*SHIP LOOSE

\*\*ONE INSTALLED, ONE SHIPPED LOOSE

**LIGHTHEAD INSTALLATION**

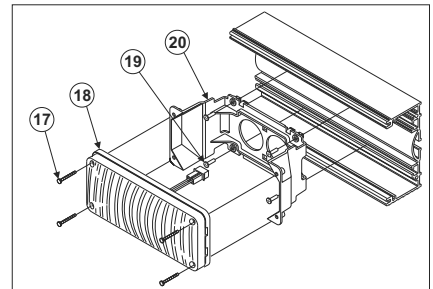

**PINOUT**

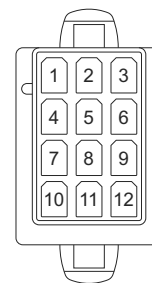

POS.	COLOR
1	BROWN
2	RED
3	ORANGE
4	YELLOW
5	GREEN
6	BLUE
7	VIOLET
8	GREY
9	WHITE
10	N/C
11	N/C
12	N/C