

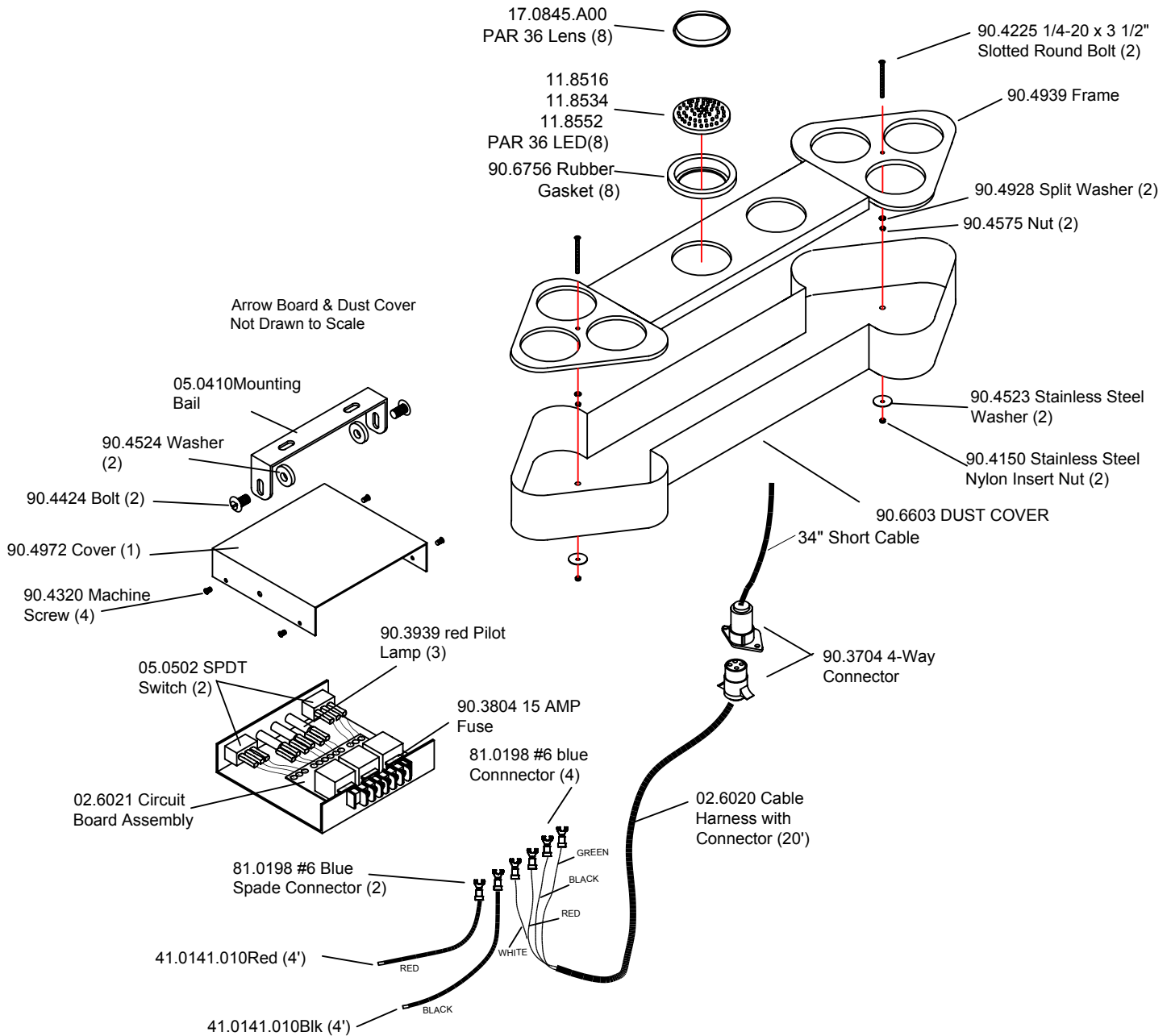

Installation and Maintenance Instructions For Model No. 02.6316 - 6334 - 6352 Arrow Board with Control Box



PRODUCTS COMPANY 804 East Hwy 248 Cassville, MO 65625
 U.S. and Canada Toll Free Numbers Phone: 800-641-4098 FAX: 800-526-1240
 E-mail: sales@able2products.com WEB: www.able2products.com

Installation and Maintenance Instructions For

Model No. 02.6316-6334-6352 LED Arrow Board with Controller

All connections are external. There is no need to open the control box during the installation process.

1. Remove dust cover by removing the two lock nuts and washers located on the back of the arrow board.
2. Mount the **SHO-ME**® LED Arrow Board on the vehicle as desired.
3. Replace dust cover.
4. Route the cable from the Arrow Board to the driver's compartment or wherever the control box will be located.
5. A mounting bracket is provided for easy installation of the control box. Determine a suitable position for the mounting bracket and attach it to the vehicle with appropriate fasteners.
6. Connect the bare end of **HEAVY BLACK** wire to a suitable chassis ground.
7. Connect spade connector of **HEAVY BLACK** wire to screw marked "NEG" on terminal strip.
8. Connect spade connector of White wire from Arrow Board cable to screw marked "W" on terminal strip.
9. Connect spade connector of Red wire from Arrow Board cable to screw marked "R" on terminal strip.
10. Connect spade connector of Black wire from Arrow Board cable to screw marked "B" on terminal strip.
11. Connect spade connector of Green wire from Arrow Board cable to screw marked "G" on terminal strip.
12. Connect spade connector of **HEAVY RED** wire to screw marked "POS" on terminal strip.
13. Connect bare end of the **HEAVY RED** wire to a 12-volt positive power source.
14. Assemble the control box to the bracket.

****NOTE****

These instructions assume that the Arrow Board is facing the rear of the vehicle. However, if the arrow board is flashing to the left when the pilot lamps on the control box indicate that it should be flashing to the right and vice versa, the situation can be corrected by connecting the white wire to the terminal marked "G", and the green wire to the terminal marked "W".

After completing the installation, always check the direction that the Arrow Board Panels are flashing, and be sure that it coincides with the direction indicated by the control box pilot lamps.

MAINTENANCE INSTRUCTIONS

TROUBLE SHOOTING

1. If the **SHO-ME**® LED Arrow Board is not operating properly or is not lighting to full brilliance, make sure all wire connections made during the installation process are secure and the power source is active. Take particular care in making certain that ground connections are properly made.
2. If the Arrow Board is still not working, check the internal 10 amp fuse, in the controller.

Wiring for 02.6316-6334-6352 LED Arrow Boards

